

"light line" Illustrated Book

Exterior

The color scheme emphasizes the power of "lightning (thunderbolt)" and the "advancement" leading Haga-Utsunomiya with a yellow L-shaped coloring that highlights the front of the vehicle.

The characteristic of the shape is the use of large glass on the front of the vehicle, expressing a flowing front shape, and connecting a dynamic line from the side to the front, extending to the pillar (the front pillar) to represent the sharp image of an arrowhead.



Driver's seat

- One-man operation
- Maximum driving speed is 40km/h

Nose

- The design is based on the L-shape of the LRT and has a flowing front shape.

Interior



Pantograph

- Device for taking in power from overhead lines
- Eco-friendly as it is powered by an electric motor

Overhead wire

- Electricity flows through it to power it
- The 750V system, first in Japan, was adopted due to its advantages in reducing electrical losses such as voltage drops and its economic benefits for equipment like overhead lines.

Penetrating hood

- The cover between coupled vehicles is installed to prevent passengers from falling and to protect against wind and rain.



Low-floor Design

- The boarding and alighting entrance is a low-floor design with a height of 30 cm. It is aligned with the height of the stop, so there is almost no gap, making it easy for wheelchair users and the elderly to board and alight smoothly.

Rail

- Runs on rails called track

The boarding and alighting entrance

- Payment can be made with transportation IC cards at all doors.

Window

- Large windows are used to enjoy the view outside

Comparison of Transport Capacity



Route bus: approx. 10m



Compact car approx. 4m

One train set: Approximately 160

The vehicle's capacity is one of the largest in Japan, accommodating about 160 people with 50 seats, and incorporates universal design with priority seating. It boasts excellent transport capacity and a comfortable ride with minimal vibration.

Equivalent to 3.2 buses

(calculated at approximately 50 people per bus)

Equivalent to 107 cars

(calculated at approximately 1.5 people per car)

Proof of Payment (Self-boarding and Alighting) System Utilizing Transportation IC Cards

All doors of the vehicles have boarding and alighting readers installed on both sides to facilitate smooth boarding and alighting from all doors using transportation IC cards, adopting a "Proof of Payment (Self-boarding and Alighting) System."

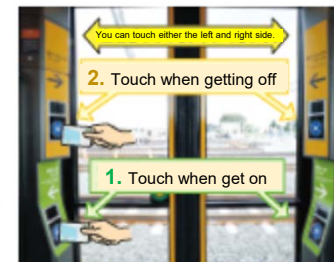
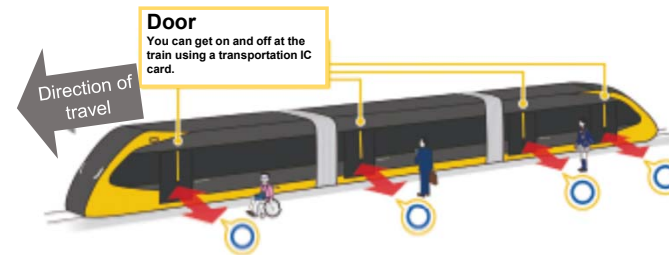

▲IC card readers installed on both sides of all vehicle doors