

座標面積計算書

| | | | | | | | 地番 | 平松4丁目100番 | 地目 | |
|-------------------------|-----------|-----------|----------|--------|-----------|----|--------|-----------|----|--|
| No | 境界点 | X | Y | 辺長 | 方向角 | 備考 | | | | |
| 1 | B91-KR04 | 60240.454 | 7498.083 | 5.007 | 255-14-06 | | | | | |
| 2 | B91-KR03 | 60239.178 | 7493.241 | 8.044 | 214-10-52 | | | | | |
| 3 | B90-K34 | 60232.524 | 7488.722 | 4.998 | 165-15-54 | | | | | |
| 4 | B90-K33 | 60227.691 | 7489.993 | 9.242 | 212-39-08 | | | | | |
| 5 | B90-K32 | 60219.909 | 7485.006 | 12.570 | 213-16-27 | | | | | |
| 6 | B90-KC201 | 60209.400 | 7478.110 | 2.410 | 213-16-27 | | | | | |
| 7 | B90-K30 | 60207.385 | 7476.788 | 6.352 | 213-48-45 | | | | | |
| 8 | B90-KC28 | 60202.108 | 7473.253 | 8.321 | 213-48-45 | | | | | |
| 9 | B90-K27 | 60195.194 | 7468.623 | 2.975 | 214-26-16 | | | | | |
| 10 | B90-K26 | 60192.740 | 7466.940 | 11.749 | 214-23-24 | | | | | |
| 11 | B90-K25 | 60183.045 | 7460.304 | 8.749 | 214-57-40 | | | | | |
| 12 | B90-K24 | 60175.874 | 7455.291 | 6.215 | 214-55-39 | | | | | |
| 13 | B90-K23 | 60170.779 | 7451.732 | 13.777 | 215-33-47 | | | | | |
| 14 | B90-K22 | 60159.572 | 7443.720 | 3.616 | 216-08-02 | | | | | |
| 15 | B90-K21 | 60156.651 | 7441.587 | 12.289 | 216-04-45 | | | | | |
| 16 | B90-K20 | 60146.719 | 7434.351 | 14.832 | 216-38-13 | | | | | |
| 17 | B90-K19 | 60134.818 | 7425.500 | 7.927 | 217-14-01 | | | | | |
| 18 | B90-K17 | 60128.506 | 7420.703 | 6.920 | 217-14-59 | | | | | |
| 19 | B90-K16 | 60122.998 | 7416.515 | 13.242 | 217-47-38 | | | | | |
| 20 | B90-K15 | 60112.534 | 7408.400 | 7.970 | 218-19-16 | | | | | |
| 21 | B90-K14 | 60106.281 | 7403.458 | 8.473 | 218-23-58 | | | | | |
| 22 | B90-K13 | 60099.641 | 7398.195 | 10.571 | 218-58-55 | | | | | |
| 23 | B90-K12 | 60091.424 | 7391.545 | 4.250 | 218-52-38 | | | | | |
| 面積算出公式 | | | | 面積 | | | 土地の所在 | | | |
| A=1/2∑Xn(Y(n+1)-Y(n-1)) | | | | 地積 | | | 土地の所有者 | | | |

座標面積計算書

| | | | | | | | 地番 | 平松4丁目100番 | 地目 | | | | | |
|----------------------------|---------|-----------|----------|--------|-----------|----|----|-----------|----|--|--------|--|--|--|
| No | 境界点 | X | Y | 辺長 | 方向角 | 備考 | | | | | | | | |
| 24 | B90-K11 | 60088.115 | 7388.877 | 0.660 | 219-47-21 | | | | | | | | | |
| 25 | B90-K10 | 60087.608 | 7388.455 | 14.173 | 219-34-39 | | | | | | | | | |
| 26 | B90-K9 | 60076.684 | 7379.425 | 14.868 | 220-03-27 | | | | | | | | | |
| 27 | B90-K8 | 60065.304 | 7369.857 | 2.160 | 220-51-16 | | | | | | | | | |
| 28 | B90-K7 | 60063.670 | 7368.444 | 12.673 | 220-42-48 | | | | | | | | | |
| 29 | B90-K5 | 60054.064 | 7360.177 | 9.369 | 221-15-46 | | | | | | | | | |
| 30 | B90-K4 | 60047.022 | 7353.998 | 4.254 | 220-58-45 | | | | | | | | | |
| 31 | B78-K62 | 60043.810 | 7351.209 | 1.229 | 221-32-30 | | | | | | | | | |
| 32 | B78-K61 | 60042.890 | 7350.394 | 14.845 | 221-50-11 | | | | | | | | | |
| 33 | B78-K60 | 60031.830 | 7340.492 | 5.170 | 222-06-20 | | | | | | | | | |
| 34 | B78-K59 | 60027.995 | 7337.026 | 8.359 | 222-13-49 | | | | | | | | | |
| 35 | B78-K58 | 60021.805 | 7331.408 | 12.166 | 257-36-26 | | | | | | | | | |
| 36 | B78-K57 | 60019.194 | 7319.525 | 20.871 | 232-00-44 | | | | | | | | | |
| 37 | B77-K12 | 60006.348 | 7303.075 | 12.007 | 167-33-04 | | | | | | | | | |
| 38 | B77-K11 | 59994.623 | 7305.664 | 8.386 | 224-00-04 | | | | | | | | | |
| 39 | B77-K10 | 59988.591 | 7299.838 | 3.834 | 224-50-12 | | | | | | | | | |
| 40 | B77-K9 | 59985.872 | 7297.135 | 10.099 | 224-40-07 | | | | | | | | | |
| 41 | B77-D1 | 59978.690 | 7290.036 | 27.199 | 111-26-16 | | | | | | | | | |
| 42 | B47-KR1 | 59968.749 | 7315.352 | 3.332 | 44-43-49 | | | | | | | | | |
| 43 | B47-K52 | 59971.117 | 7317.697 | 15.082 | 44-04-40 | | | | | | | | | |
| 44 | B47-K51 | 59981.952 | 7328.189 | 7.350 | 43-33-03 | | | | | | | | | |
| 45 | B47-K50 | 59987.278 | 7333.253 | 11.995 | 77-27-04 | | | | | | | | | |
| 46 | B47-K49 | 59989.885 | 7344.962 | 20.739 | 51-28-29 | | | | | | | | | |
| 面積算出公式 | | | | 面積 | | | | | | | 土地の所在 | | | |
| A=1/2 Σ Xn (Y(n+1)-Y(n-1)) | | | | 地積 | | | | | | | 土地の所有者 | | | |

座標面積計算書

| | | | | | | | 地番 | 平松4丁目100番 | 地目 | |
|----------------------------|----------|-----------|----------|--------|-----------|----|--------|-----------|----|--|
| No | 境界点 | X | Y | 辺長 | 方向角 | 備考 | | | | |
| 47 | B38-K2 | 60002.802 | 7361.187 | 12.007 | 347-17-25 | | | | | |
| 48 | B38-K1 | 60014.515 | 7358.545 | 1.163 | 42-54-46 | | | | | |
| 49 | B38-K96 | 60015.367 | 7359.337 | 10.414 | 41-42-41 | | | | | |
| 50 | B38-K95 | 60023.141 | 7366.266 | 4.227 | 41-54-54 | | | | | |
| 51 | B38-K94 | 60026.287 | 7369.090 | 12.920 | 41-17-21 | | | | | |
| 52 | B38-K93 | 60035.995 | 7377.615 | 1.713 | 40-50-49 | | | | | |
| 53 | B38-K92 | 60037.291 | 7378.736 | 15.809 | 40-42-28 | | | | | |
| 54 | B38-K91 | 60049.274 | 7389.046 | 7.080 | 40-07-14 | | | | | |
| 55 | B38-KR90 | 60054.688 | 7393.608 | 4.001 | 39-50-17 | | | | | |
| 56 | B30-KR1 | 60057.760 | 7396.171 | 3.783 | 40-22-17 | | | | | |
| 57 | B30-K50 | 60060.642 | 7398.622 | 6.273 | 39-26-11 | | | | | |
| 58 | B30-KC49 | 60065.487 | 7402.606 | 3.682 | 39-26-11 | | | | | |
| 59 | B30-K47 | 60068.331 | 7404.945 | 5.150 | 39-39-21 | | | | | |
| 60 | B30-K46 | 60072.295 | 7408.232 | 15.071 | 38-58-28 | | | | | |
| 61 | B30-K45 | 60084.012 | 7417.711 | 15.110 | 38-22-02 | | | | | |
| 62 | B30-K44 | 60095.859 | 7427.090 | 9.750 | 37-50-04 | | | | | |
| 63 | B30-K43 | 60103.560 | 7433.070 | 5.337 | 37-50-56 | | | | | |
| 64 | B30-K42 | 60107.774 | 7436.345 | 15.088 | 37-14-16 | | | | | |
| 65 | B30-K41 | 60119.786 | 7445.475 | 15.082 | 36-40-22 | | | | | |
| 66 | B30-K38 | 60131.883 | 7454.483 | 13.074 | 36-09-28 | | | | | |
| 67 | B30-KC36 | 60142.439 | 7462.197 | 1.525 | 36-09-28 | | | | | |
| 68 | B30-K210 | 60143.670 | 7463.097 | 0.493 | 35-41-54 | | | | | |
| 69 | B30-K209 | 60144.071 | 7463.385 | 11.126 | 35-30-02 | | | | | |
| 面積算出公式 | | | | 面積 | | | 土地の所在 | | | |
| A=1/2 Σ Xn (Y(n+1)-Y(n-1)) | | | | 地積 | | | 土地の所有者 | | | |

座標面積計算書

| | | | | | | | 地番 | 平松4丁目100番 | 地目 | | | | |
|----------------------------|-----------|-----------|----------|--------|-------------|--------|----|-----------|----|--|--|--|--|
| No | 境界点 | X | Y | 辺長 | 方向角 | 備考 | | | | | | | |
| 70 | B30-K208 | 60153.129 | 7469.845 | 3.959 | 35-31-12 | | | | | | | | |
| 71 | B30-K207 | 60156.351 | 7472.146 | 15.094 | 34-57-49 | | | | | | | | |
| 72 | B30-K206 | 60168.721 | 7480.795 | 1.803 | 34-26-07 | | | | | | | | |
| 73 | B30-K205 | 60170.208 | 7481.815 | 7.016 | 34-23-30 | | | | | | | | |
| 74 | B30-KC204 | 60175.998 | 7485.778 | 6.292 | 34-23-30 | | | | | | | | |
| 75 | B30-K203 | 60181.190 | 7489.332 | 9.572 | 33-52-07 | | | | | | | | |
| 76 | B30-KC202 | 60189.138 | 7494.667 | 5.512 | 33-50-33 | | | | | | | | |
| 77 | B30-K201 | 60193.716 | 7497.736 | 9.746 | 33-14-47 | | | | | | | | |
| 78 | B30-K200 | 60201.866 | 7503.079 | 5.340 | 33-10-57 | | | | | | | | |
| 79 | B30-K35 | 60206.336 | 7506.002 | 4.667 | 32-34-49 | | | | | | | | |
| 80 | B30-KC34 | 60210.268 | 7508.515 | 1.235 | 32-34-49 | | | | | | | | |
| 81 | B30-KC33 | 60211.309 | 7509.180 | 5.847 | 32-34-49 | | | | | | | | |
| 82 | B30-K32 | 60216.236 | 7512.329 | 5.000 | 75-22-16 | | | | | | | | |
| 83 | B30-K31 | 60217.499 | 7517.166 | 8.062 | 33-42-16 | | | | | | | | |
| 84 | B29-K2 | 60224.206 | 7521.640 | 4.967 | 345-20-04 | | | | | | | | |
| 85 | B29-K1 | 60229.011 | 7520.383 | 25.065 | 297-09-56 | | | | | | | | |
| | | | | | | | | | | | | | |
| | | | | | | | | | | | | | |
| | | | | | | | | | | | | | |
| | | | | | | | | | | | | | |
| | | | | | | | | | | | | | |
| | | | | | | | | | | | | | |
| | | | | | | | | | | | | | |
| | | | | | | | | | | | | | |
| | | | | | | | | | | | | | |
| | | | | | | | | | | | | | |
| 面積算出公式 | | | | 面積 | 8899.086373 | 土地の所在 | | | | | | | |
| A=1/2 Σ Xn (Y(n+1)-Y(n-1)) | | | | 地積 | 8899.08 | 土地の所有者 | | | | | | | |

座標面積計算書

| | | | |
|----|-----------|----|--|
| 地番 | 平松4丁目101番 | 地目 | |
|----|-----------|----|--|

| No | 境界点 | X | Y | 辺長 | 方向角 | 備考 |
|----|----------|-----------|----------|--------|-----------|----|
| 1 | B29-K2 | 60224.206 | 7521.640 | 8.062 | 213-42-16 | |
| 2 | B30-K31 | 60217.499 | 7517.166 | 7.697 | 117-46-49 | |
| 3 | B30-KT30 | 60213.911 | 7523.976 | 12.523 | 117-46-49 | |
| 4 | B30-K29 | 60208.075 | 7535.056 | 0.952 | 117-44-36 | |
| 5 | B30-KC28 | 60207.631 | 7535.899 | 1.064 | 117-44-36 | |
| 6 | B30-KT27 | 60207.136 | 7536.841 | 7.495 | 117-44-36 | |
| 7 | B30-K26 | 60203.647 | 7543.474 | 13.131 | 117-51-09 | |
| 8 | B31-K28 | 60197.512 | 7555.084 | 12.854 | 117-48-18 | |
| 9 | B31-K27 | 60191.516 | 7566.454 | 7.754 | 117-49-29 | |
| 10 | B31-K46 | 60187.897 | 7573.311 | 7.738 | 117-48-20 | |
| 11 | B31-K26 | 60184.287 | 7580.155 | 14.791 | 117-48-04 | |
| 12 | B31-K25 | 60177.389 | 7593.239 | 1.997 | 117-49-49 | |
| 13 | B31-KC24 | 60176.457 | 7595.005 | 19.305 | 117-49-49 | |
| 14 | B31-K23 | 60167.444 | 7612.077 | 44.329 | 117-48-39 | |
| 15 | B31-K22 | 60146.762 | 7651.287 | 0.973 | 117-53-24 | |
| 16 | B31-K21 | 60146.306 | 7652.147 | 13.201 | 117-49-29 | |
| 17 | B31-K20 | 60140.144 | 7663.822 | 0.952 | 117-50-26 | |
| 18 | B31-K19 | 60139.700 | 7664.664 | 9.596 | 117-45-19 | |
| 19 | B31-K18 | 60135.231 | 7673.155 | 7.971 | 27-49-59 | |
| 20 | B27-K8 | 60142.280 | 7676.877 | 13.627 | 297-48-38 | |
| 21 | B27-KC7 | 60148.638 | 7664.824 | 14.477 | 297-48-38 | |
| 22 | B27-K5 | 60155.392 | 7652.019 | 14.012 | 297-52-48 | |
| 23 | B27-KC4 | 60161.944 | 7639.634 | 3.527 | 297-52-48 | |

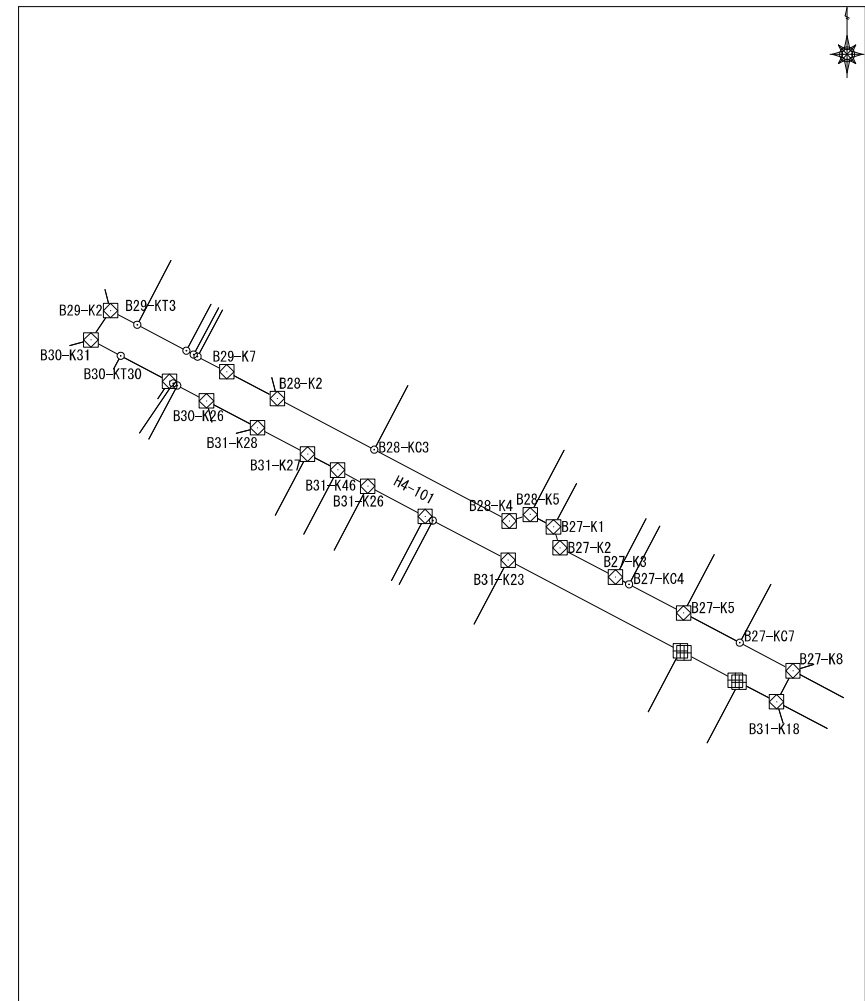

| | | | | |
|--|----|--|--------|--|
| 面積算出公式 $A=1/2 \sum X_n (Y_{(n+1)} - Y_{(n-1)})$ | 面積 | | 土地の所在 | |
| | 地積 | | 土地の所有者 | |

座標面積計算書

| | | | | | | | 地番 | 平松4丁目102番 | 地目 | | | | | |
|----------------------------|--------|-----------|----------|-------|-------------|--------|----|-----------|----|--|--|--|--|--|
| No | 境界点 | X | Y | 辺長 | 方向角 | 備考 | | | | | | | | |
| 24 | B25-K3 | 60262.950 | 7604.630 | 8.174 | 297-48-25 | | | | | | | | | |
| 25 | B25-K2 | 60266.763 | 7597.400 | 5.005 | 342-56-39 | | | | | | | | | |
| 26 | B25-K1 | 60271.548 | 7595.932 | 6.009 | 297-47-28 | | | | | | | | | |
| | | | | | | | | | | | | | | |
| | | | | | | | | | | | | | | |
| | | | | | | | | | | | | | | |
| | | | | | | | | | | | | | | |
| | | | | | | | | | | | | | | |
| | | | | | | | | | | | | | | |
| | | | | | | | | | | | | | | |
| | | | | | | | | | | | | | | |
| | | | | | | | | | | | | | | |
| | | | | | | | | | | | | | | |
| | | | | | | | | | | | | | | |
| | | | | | | | | | | | | | | |
| | | | | | | | | | | | | | | |
| | | | | | | | | | | | | | | |
| | | | | | | | | | | | | | | |
| | | | | | | | | | | | | | | |
| | | | | | | | | | | | | | | |
| 面積算出公式 | | | | 面積 | 838.9769105 | 土地の所在 | | | | | | | | |
| A=1/2 Σ Xn (Y(n+1)-Y(n-1)) | | | | 地積 | 838.97 | 土地の所有者 | | | | | | | | |

座標面積計算書

| No | 境界点 | X | Y | 辺長 | 方向角 | 備考 |
|----|-----------|-----------|----------|--------|-----------|----|
| 1 | B30-K26 | 60203.647 | 7543.474 | 4.994 | 165-37-40 | |
| 2 | B30-K25 | 60198.809 | 7544.714 | 11.244 | 213-33-10 | |
| 3 | B30-K24 | 60189.438 | 7538.499 | 1.144 | 213-31-18 | |
| 4 | B30-KC23 | 60188.484 | 7537.867 | 8.339 | 213-31-18 | |
| 5 | B30-K214 | 60181.532 | 7533.262 | 8.697 | 213-37-32 | |
| 6 | B30-K213 | 60174.291 | 7528.446 | 6.555 | 214-01-56 | |
| 7 | B30-KC212 | 60168.858 | 7524.777 | 22.890 | 214-00-20 | |
| 8 | B30-K211 | 60149.882 | 7511.975 | 9.436 | 213-58-05 | |
| 9 | B30-K22 | 60142.057 | 7506.703 | 6.409 | 215-27-04 | |
| 10 | B30-K21 | 60136.835 | 7502.986 | 3.011 | 215-34-18 | |
| 11 | B30-K20 | 60134.387 | 7501.234 | 2.001 | 215-41-51 | |
| 12 | B30-K19 | 60132.761 | 7500.066 | 8.335 | 215-31-17 | |
| 13 | B30-K18 | 60125.977 | 7495.224 | 4.635 | 215-34-02 | |
| 14 | B30-K17 | 60122.208 | 7492.528 | 4.268 | 215-30-01 | |
| 15 | B30-KT16 | 60118.733 | 7490.049 | 4.081 | 215-30-01 | |
| 16 | B30-KC15 | 60115.411 | 7487.680 | 5.925 | 215-30-01 | |
| 17 | B30-K14 | 60110.587 | 7484.239 | 3.263 | 215-31-03 | |
| 18 | B30-KC13 | 60107.931 | 7482.343 | 6.973 | 215-31-03 | |
| 19 | B30-K12 | 60102.256 | 7478.293 | 14.723 | 215-29-03 | |
| 20 | B30-KC11 | 60090.267 | 7469.746 | 4.811 | 215-29-03 | |
| 21 | B30-KC10 | 60086.350 | 7466.954 | 6.104 | 215-29-03 | |
| 22 | B30-K9 | 60081.380 | 7463.410 | 1.084 | 219-41-27 | |
| 23 | B30-K8 | 60080.546 | 7462.718 | 39.693 | 219-53-26 | |

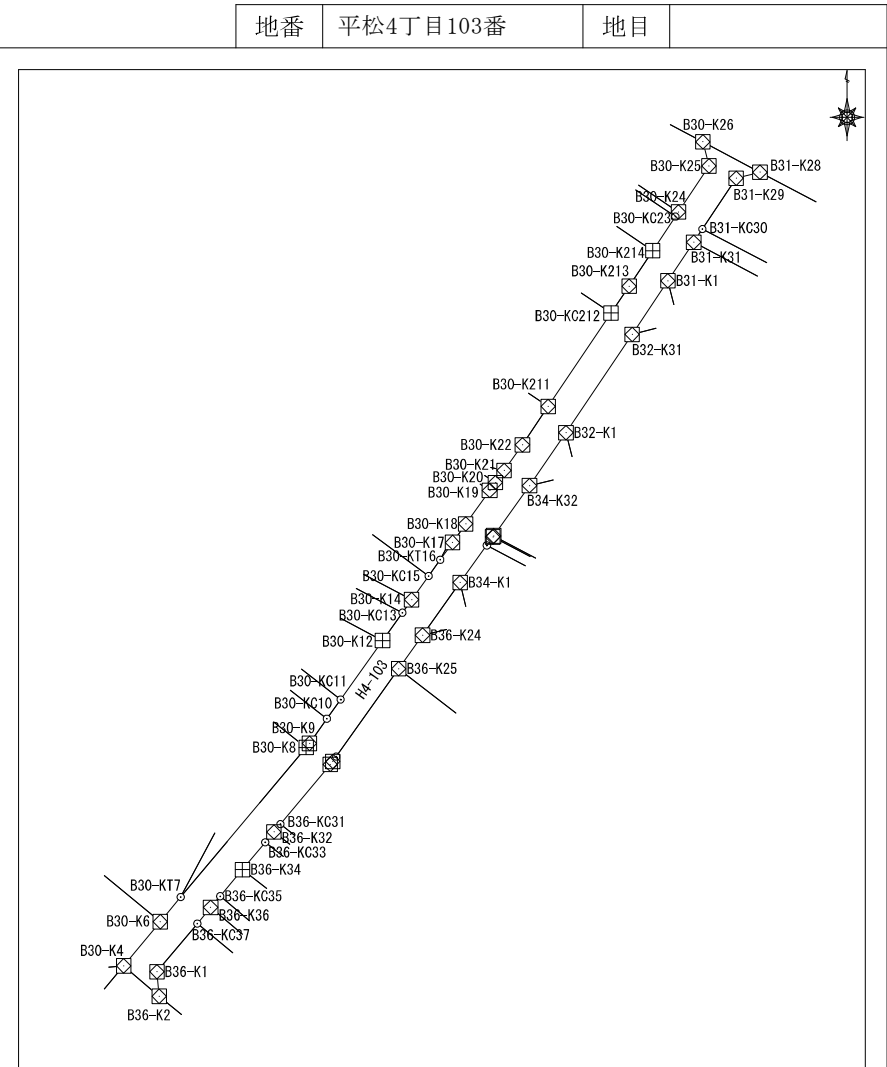

| | | |
|--|----|--------|
| 面積算出公式 | 面積 | 土地の所在 |
| $A=1/2 \sum X_n (Y_{(n+1)} - Y_{(n-1)})$ | 地積 | 土地の所有者 |

座標面積計算書

| | | | | | | | 地番 | 平松4丁目103番 | 地目 | | | | | |
|----------------------------|----------|-----------|----------|--------|-----------|----|----|-----------|----|--|--------|--|--|--|
| No | 境界点 | X | Y | 辺長 | 方向角 | 備考 | | | | | | | | |
| 24 | B30-KT7 | 60050.091 | 7437.262 | 6.504 | 219-53-26 | | | | | | | | | |
| 25 | B30-K6 | 60045.101 | 7433.091 | 11.656 | 219-51-04 | | | | | | | | | |
| 26 | B30-K4 | 60036.152 | 7425.622 | 9.544 | 130-29-32 | | | | | | | | | |
| 27 | B36-K2 | 60029.955 | 7432.880 | 5.014 | 354-47-52 | | | | | | | | | |
| 28 | B36-K1 | 60034.948 | 7432.426 | 12.793 | 39-55-04 | | | | | | | | | |
| 29 | B36-KC37 | 60044.760 | 7440.635 | 4.195 | 39-55-04 | | | | | | | | | |
| 30 | B36-K36 | 60047.978 | 7443.327 | 2.965 | 39-52-29 | | | | | | | | | |
| 31 | B36-KC35 | 60050.253 | 7445.228 | 7.075 | 39-52-29 | | | | | | | | | |
| 32 | B36-K34 | 60055.683 | 7449.763 | 7.259 | 39-51-15 | | | | | | | | | |
| 33 | B36-KC33 | 60061.255 | 7454.415 | 2.741 | 39-51-15 | | | | | | | | | |
| 34 | B36-K32 | 60063.359 | 7456.171 | 2.066 | 39-51-04 | | | | | | | | | |
| 35 | B36-KC31 | 60064.945 | 7457.495 | 15.813 | 39-51-04 | | | | | | | | | |
| 36 | B36-K28 | 60077.085 | 7467.628 | 0.822 | 39-58-17 | | | | | | | | | |
| 37 | B36-K27 | 60077.715 | 7468.157 | 1.204 | 35-30-51 | | | | | | | | | |
| 38 | B36-KT26 | 60078.695 | 7468.856 | 21.895 | 35-30-51 | | | | | | | | | |
| 39 | B36-K25 | 60096.517 | 7481.575 | 8.414 | 35-30-45 | | | | | | | | | |
| 40 | B36-K24 | 60103.366 | 7486.462 | 13.173 | 35-30-46 | | | | | | | | | |
| 41 | B34-K1 | 60114.089 | 7494.114 | 9.299 | 35-31-20 | | | | | | | | | |
| 42 | B34-KC35 | 60121.657 | 7499.518 | 2.073 | 35-31-20 | | | | | | | | | |
| 43 | B34-K34 | 60123.344 | 7500.722 | 0.267 | 35-15-41 | | | | | | | | | |
| 44 | B34-K33 | 60123.563 | 7500.876 | 12.539 | 35-30-12 | | | | | | | | | |
| 45 | B34-K32 | 60133.770 | 7508.158 | 13.087 | 34-39-28 | | | | | | | | | |
| 46 | B32-K1 | 60144.535 | 7515.600 | 24.081 | 34-00-46 | | | | | | | | | |
| 面積算出公式 | | | | 面積 | | | | | | | 土地の所在 | | | |
| A=1/2 Σ Xn (Y(n+1)-Y(n-1)) | | | | 地積 | | | | | | | 土地の所有者 | | | |

座標面積計算書

| | | | |
|----|-----------|----|--|
| 地番 | 平松4丁目104番 | 地目 | |
|----|-----------|----|--|

| No | 境界点 | X | Y | 辺長 | 方向角 | 備考 |
|----|----------|-----------|----------|--------|-----------|----|
| 1 | B31-K1 | 60175.403 | 7536.351 | 13.114 | 213-43-27 | |
| 2 | B32-K31 | 60164.496 | 7529.070 | 4.989 | 75-40-09 | |
| 3 | B32-K30 | 60165.731 | 7533.904 | 19.305 | 117-49-16 | |
| 4 | B32-K29 | 60156.721 | 7550.977 | 10.332 | 117-48-50 | |
| 5 | B32-K28 | 60151.900 | 7560.115 | 10.318 | 117-53-36 | |
| 6 | B32-K27 | 60147.073 | 7569.234 | 10.299 | 117-47-25 | |
| 7 | B32-K26 | 60142.271 | 7578.345 | 10.320 | 117-50-43 | |
| 8 | B32-K25 | 60137.451 | 7587.471 | 10.299 | 117-48-15 | |
| 9 | B32-K24 | 60132.647 | 7596.580 | 10.310 | 117-50-31 | |
| 10 | B32-K23 | 60127.832 | 7605.697 | 10.309 | 117-47-06 | |
| 11 | B32-K22 | 60123.027 | 7614.817 | 15.784 | 117-50-20 | |
| 12 | B32-K21 | 60115.656 | 7628.774 | 0.827 | 117-48-39 | |
| 13 | B32-KC20 | 60115.270 | 7629.505 | 8.350 | 117-48-39 | |
| 14 | B32-KC19 | 60111.374 | 7636.891 | 2.173 | 117-48-39 | |
| 15 | B32-K18 | 60110.360 | 7638.813 | 10.876 | 117-48-52 | |
| 16 | B32-K17 | 60105.285 | 7648.432 | 7.907 | 117-48-47 | |
| 17 | B32-K16 | 60101.596 | 7655.426 | 5.983 | 27-40-33 | |
| 18 | B31-K14 | 60106.894 | 7658.205 | 10.788 | 297-50-21 | |
| 19 | B31-K12 | 60111.932 | 7648.666 | 13.931 | 297-50-22 | |
| 20 | B31-K10 | 60118.438 | 7636.347 | 12.104 | 297-48-00 | |
| 21 | B31-K9 | 60124.083 | 7625.640 | 12.087 | 297-49-15 | |
| 22 | B31-K8 | 60129.724 | 7614.950 | 20.148 | 297-49-10 | |
| 23 | B31-K7 | 60139.127 | 7597.131 | 19.294 | 297-50-14 | |

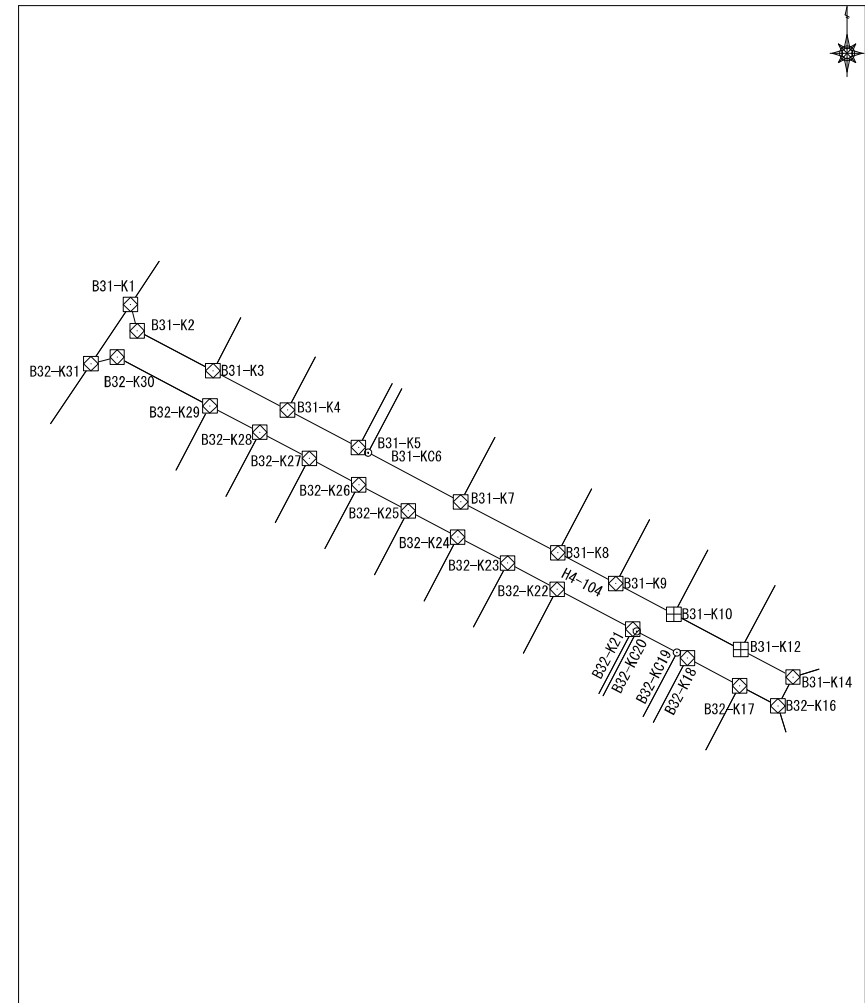

| | | |
|---|----|--|
| 面積算出公式 $A=1/2 \sum X_n(Y_{(n+1)}-Y_{(n-1)})$ | 面積 | |
| | 地積 | |

| | |
|--------|--|
| 土地の所在 | |
| 土地の所有者 | |

座標面積計算書

| | | | |
|----|-----------|----|--|
| 地番 | 平松4丁目105番 | 地目 | |
|----|-----------|----|--|

| No | 境界点 | X | Y | 辺長 | 方向角 | 備考 |
|----|----------|-----------|----------|--------|-----------|----|
| 1 | B32-K1 | 60144.535 | 7515.600 | 13.087 | 214-39-28 | |
| 2 | B34-K32 | 60133.770 | 7508.158 | 4.978 | 76-42-15 | |
| 3 | B34-K31 | 60134.915 | 7513.003 | 4.244 | 117-48-14 | |
| 4 | B34-K30 | 60132.936 | 7516.757 | 3.519 | 117-48-40 | |
| 5 | B34-KC27 | 60131.294 | 7519.869 | 11.152 | 117-48-40 | |
| 6 | B34-KC26 | 60126.091 | 7529.733 | 2.171 | 117-48-40 | |
| 7 | B34-K25 | 60125.078 | 7531.654 | 20.527 | 117-49-29 | |
| 8 | B34-KC24 | 60115.496 | 7549.807 | 14.888 | 117-49-29 | |
| 9 | B34-KC23 | 60108.547 | 7562.974 | 24.891 | 117-49-29 | |
| 10 | B34-K22 | 60096.929 | 7584.987 | 0.316 | 117-49-02 | |
| 11 | B34-KC21 | 60096.781 | 7585.266 | 18.622 | 117-49-02 | |
| 12 | B34-K20 | 60088.091 | 7601.737 | 40.991 | 117-48-51 | |
| 13 | B33-K16 | 60068.965 | 7637.991 | 5.995 | 29-25-23 | |
| 14 | B32-K12 | 60074.186 | 7640.936 | 11.898 | 297-50-06 | |
| 15 | B32-K11 | 60079.742 | 7630.415 | 14.399 | 297-48-58 | |
| 16 | B32-K10 | 60086.461 | 7617.680 | 19.592 | 297-50-19 | |
| 17 | B32-K9 | 60095.610 | 7600.356 | 12.002 | 297-50-02 | |
| 18 | B32-K8 | 60101.214 | 7589.742 | 12.009 | 297-47-15 | |
| 19 | B32-K7 | 60106.812 | 7579.118 | 11.987 | 297-51-31 | |
| 20 | B32-K6 | 60112.414 | 7568.520 | 11.996 | 297-47-05 | |
| 21 | B32-K5 | 60118.006 | 7557.907 | 12.120 | 297-49-42 | |
| 22 | B32-K4 | 60123.663 | 7547.189 | 12.077 | 297-48-36 | |
| 23 | B32-K3 | 60129.298 | 7536.507 | 22.261 | 297-49-57 | |

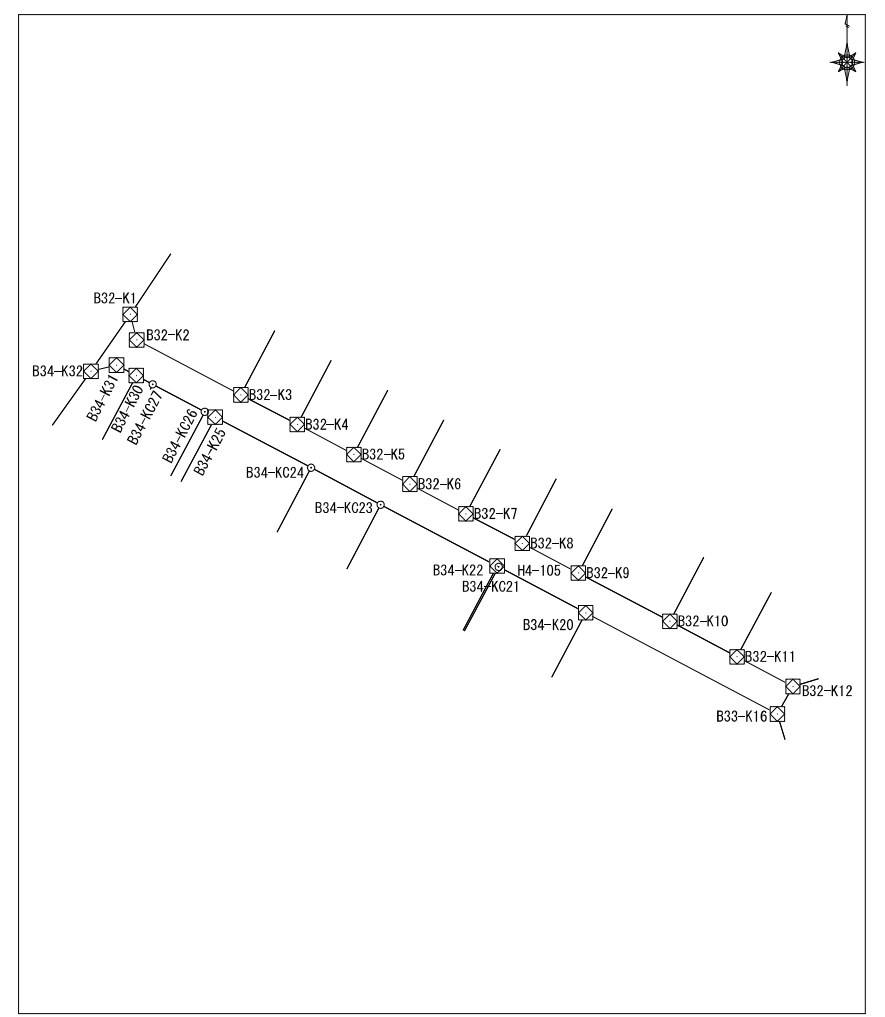

| | | | | |
|---|----|--|--------|--|
| 面積算出公式 $A=1/2 \sum X_n(Y_{(n+1)}-Y_{(n-1)})$ | 面積 | | 土地の所在 | |
| | 地積 | | 土地の所有者 | |

座標面積計算書

| | | | |
|----|-----------|----|--|
| 地番 | 平松4丁目106番 | 地目 | |
|----|-----------|----|--|

| No | 境界点 | X | Y | 辺長 | 方向角 | 備考 |
|----|----------|-----------|----------|--------|-----------|----|
| 1 | B34-K1 | 60114.089 | 7494.114 | 13.173 | 215-30-46 | |
| 2 | B36-K24 | 60103.366 | 7486.462 | 5.002 | 76-37-02 | |
| 3 | B36-K23 | 60104.524 | 7491.329 | 15.210 | 117-52-22 | |
| 4 | B36-K22 | 60097.413 | 7504.774 | 13.382 | 117-48-12 | |
| 5 | B36-K21 | 60091.171 | 7516.611 | 13.225 | 117-47-47 | |
| 6 | B35-K20 | 60085.004 | 7528.310 | 70.242 | 117-49-34 | |
| 7 | B35-K19 | 60052.215 | 7590.430 | 3.997 | 134-22-26 | |
| 8 | B35-K18 | 60049.420 | 7593.287 | 18.205 | 150-53-37 | |
| 9 | B35-K17 | 60033.515 | 7602.142 | 5.984 | 58-05-23 | |
| 10 | B33-K2 | 60036.678 | 7607.222 | 21.772 | 331-01-08 | |
| 11 | B33-K1 | 60055.724 | 7596.673 | 10.633 | 297-44-40 | |
| 12 | B34-K18 | 60060.673 | 7587.263 | 13.425 | 297-48-47 | |
| 13 | B34-K17 | 60066.937 | 7575.389 | 0.771 | 297-50-30 | |
| 14 | B34-KC16 | 60067.297 | 7574.707 | 11.467 | 297-50-30 | |
| 15 | B34-K15 | 60072.653 | 7564.568 | 1.006 | 297-47-18 | |
| 16 | B34-KC14 | 60073.122 | 7563.678 | 8.979 | 297-47-18 | |
| 17 | B34-K13 | 60077.308 | 7555.734 | 1.860 | 297-48-55 | |
| 18 | B34-KC12 | 60078.176 | 7554.089 | 9.885 | 297-48-55 | |
| 19 | B34-K11 | 60082.788 | 7545.346 | 1.940 | 297-48-25 | |
| 20 | B34-KC9 | 60083.693 | 7543.630 | 13.522 | 297-48-25 | |
| 21 | B34-K8 | 60090.001 | 7531.670 | 11.384 | 297-48-40 | |
| 22 | B34-KC7 | 60095.313 | 7521.601 | 1.250 | 297-48-40 | |
| 23 | B34-K5 | 60095.896 | 7520.495 | 21.411 | 297-51-09 | |

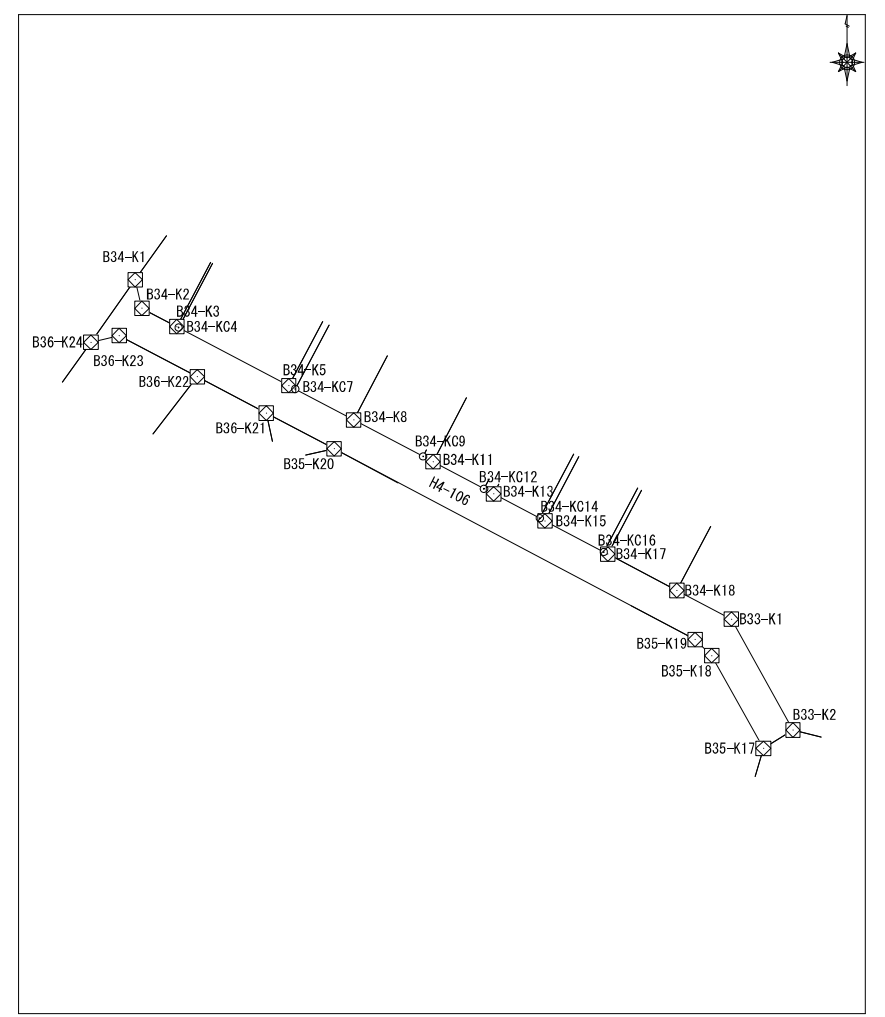

| | | | | |
|---|----|--|--------|--|
| 面積算出公式 $A=1/2 \sum X_n(Y_{(n+1)}-Y_{(n-1)})$ | 面積 | | 土地の所在 | |
| | 地積 | | 土地の所有者 | |

座標面積計算書

| | | | | | | | 地番 | 平松4丁目106番 | 地目 | | | | | | |
|----------------------------|---------|-----------|----------|-------|-------------|--------|----|-----------|----|--|--|--|--|--|--|
| No | 境界点 | X | Y | 辺長 | 方向角 | 備考 | | | | | | | | | |
| 24 | B34-KC4 | 60105.899 | 7501.565 | 0.335 | 297-51-09 | | | | | | | | | | |
| 25 | B34-K3 | 60106.055 | 7501.268 | 6.787 | 297-48-30 | | | | | | | | | | |
| 26 | B34-K2 | 60109.222 | 7495.265 | 5.001 | 346-41-44 | | | | | | | | | | |
| | | | | | | | | | | | | | | | |
| | | | | | | | | | | | | | | | |
| | | | | | | | | | | | | | | | |
| | | | | | | | | | | | | | | | |
| | | | | | | | | | | | | | | | |
| | | | | | | | | | | | | | | | |
| | | | | | | | | | | | | | | | |
| | | | | | | | | | | | | | | | |
| | | | | | | | | | | | | | | | |
| | | | | | | | | | | | | | | | |
| | | | | | | | | | | | | | | | |
| | | | | | | | | | | | | | | | |
| | | | | | | | | | | | | | | | |
| | | | | | | | | | | | | | | | |
| | | | | | | | | | | | | | | | |
| | | | | | | | | | | | | | | | |
| | | | | | | | | | | | | | | | |
| 面積算出公式 | | | | 面積 | 847.3760575 | 土地の所在 | | | | | | | | | |
| A=1/2 Σ Xn (Y(n+1)-Y(n-1)) | | | | 地積 | 847.37 | 土地の所有者 | | | | | | | | | |

座標面積計算書

| | | | |
|----|-----------|----|--|
| 地番 | 平松4丁目109番 | 地目 | |
|----|-----------|----|--|

| No | 境界点 | X | Y | 辺長 | 方向角 | 備考 |
|----|------------|-----------|----------|--------|-----------|----|
| 1 | B30-K4 | 60036.152 | 7425.622 | 6.127 | 219-34-40 | |
| 2 | B38-D1 | 60031.430 | 7421.719 | 5.113 | 129-34-40 | |
| 3 | B38-KTR207 | 60028.172 | 7425.660 | 11.178 | 129-34-40 | |
| 4 | B38-KC86 | 60021.050 | 7434.275 | 3.670 | 129-34-40 | |
| 5 | B38-KTR208 | 60018.712 | 7437.104 | 6.064 | 129-34-40 | |
| 6 | B38-KR201 | 60014.849 | 7441.777 | 3.982 | 91-15-18 | |
| 7 | B38-K83 | 60014.762 | 7445.758 | 3.440 | 91-18-47 | |
| 8 | B38-KC81 | 60014.683 | 7449.197 | 8.597 | 91-18-47 | |
| 9 | B38-K80 | 60014.486 | 7457.791 | 12.609 | 91-13-56 | |
| 10 | B38-K79 | 60014.215 | 7470.397 | 1.309 | 91-20-43 | |
| 11 | B38-KC212 | 60014.184 | 7471.706 | 1.684 | 91-20-43 | |
| 12 | B38-K78 | 60014.145 | 7473.389 | 9.719 | 91-27-37 | |
| 13 | B38-K77 | 60013.897 | 7483.104 | 0.402 | 91-16-32 | |
| 14 | B38-KC76 | 60013.888 | 7483.507 | 10.436 | 91-16-32 | |
| 15 | B38-K75 | 60013.656 | 7493.940 | 13.026 | 91-18-18 | |
| 16 | B38-K74 | 60013.359 | 7506.963 | 12.528 | 91-18-29 | |
| 17 | B38-K73 | 60013.073 | 7519.488 | 2.001 | 91-16-36 | |
| 18 | B38-KC72 | 60013.029 | 7521.488 | 13.240 | 91-16-36 | |
| 19 | B38-K71 | 60012.734 | 7534.725 | 10.981 | 91-21-03 | |
| 20 | B38-KC69 | 60012.475 | 7545.703 | 1.215 | 91-21-03 | |
| 21 | B38-K68 | 60012.446 | 7546.918 | 5.700 | 91-28-06 | |
| 22 | B38-K67 | 60012.300 | 7552.616 | 6.386 | 341-41-10 | |
| 23 | B37-K10 | 60018.362 | 7550.609 | 13.039 | 271-17-00 | |

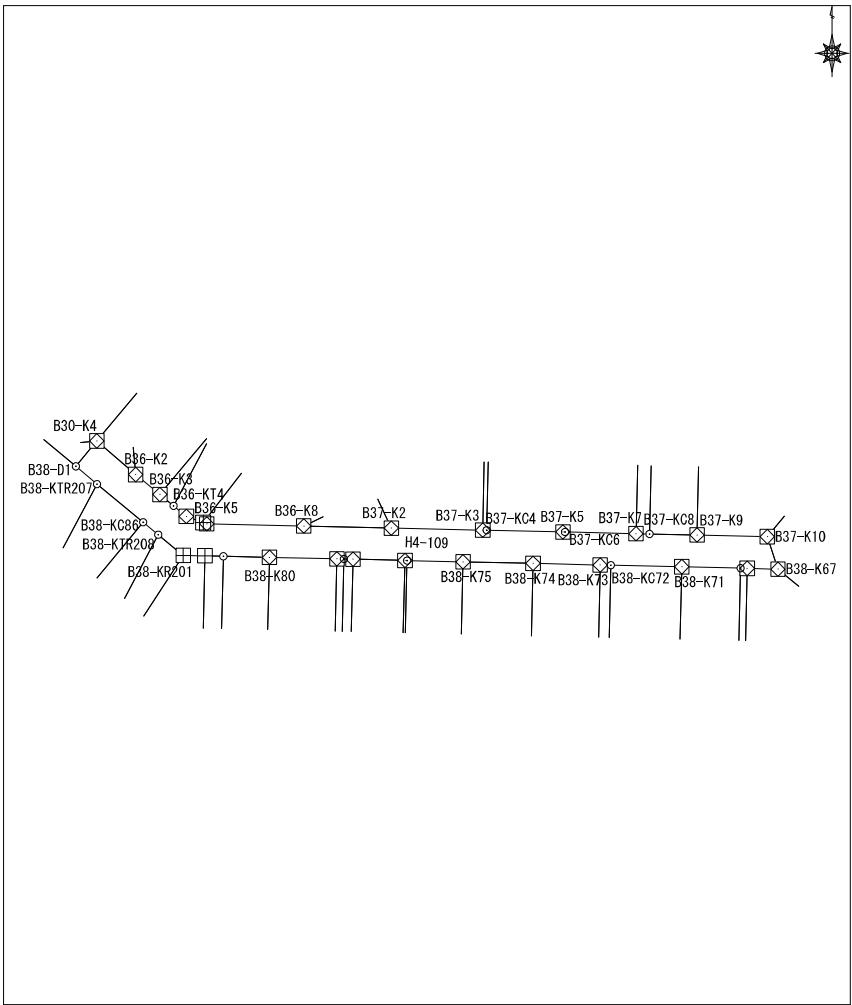

面積算出公式

$$A=1/2 \sum X_n (Y_{(n+1)} - Y_{(n-1)})$$

面積

地積

土地の所在

土地の所有者

座標面積計算書

| | | | |
|----|-----------|----|--|
| 地番 | 平松4丁目111番 | 地目 | |
|----|-----------|----|--|

| No | 境界点 | X | Y | 辺長 | 方向角 | 備考 |
|----|-----------|-----------|----------|--------|-----------|----|
| 1 | B38-K2 | 60002.802 | 7361.187 | 20.739 | 231-28-29 | |
| 2 | B47-K49 | 59989.885 | 7344.962 | 15.093 | 111-33-51 | |
| 3 | B47-K48 | 59984.337 | 7358.999 | 9.305 | 111-23-54 | |
| 4 | B47-KC47 | 59980.942 | 7367.662 | 0.981 | 111-23-54 | |
| 5 | B47-K46 | 59980.585 | 7368.575 | 0.805 | 111-30-27 | |
| 6 | B47-K45 | 59980.289 | 7369.324 | 3.055 | 111-23-01 | |
| 7 | B47-K43 | 59979.176 | 7372.168 | 1.306 | 111-15-51 | |
| 8 | B47-KC501 | 59978.702 | 7373.385 | 2.966 | 111-15-51 | |
| 9 | B47-K41 | 59977.627 | 7376.149 | 3.053 | 111-08-15 | |
| 10 | B47-K40 | 59976.526 | 7378.996 | 0.082 | 110-15-03 | |
| 11 | B47-K39 | 59976.497 | 7379.073 | 5.412 | 110-30-03 | |
| 12 | B47-K38 | 59974.602 | 7384.143 | 1.216 | 109-52-36 | |
| 13 | B47-KC37 | 59974.188 | 7385.286 | 2.456 | 109-52-36 | |
| 14 | B47-K36 | 59973.353 | 7387.596 | 1.982 | 109-22-49 | |
| 15 | B47-K34 | 59972.696 | 7389.465 | 2.313 | 108-54-07 | |
| 16 | B47-K33 | 59971.946 | 7391.654 | 3.706 | 108-18-44 | |
| 17 | B47-K31 | 59970.782 | 7395.172 | 0.096 | 106-51-10 | |
| 18 | B47-KT32 | 59970.754 | 7395.265 | 0.577 | 106-51-10 | |
| 19 | B47-KC30 | 59970.587 | 7395.817 | 3.640 | 106-51-10 | |
| 20 | B47-K29 | 59969.532 | 7399.300 | 4.300 | 105-49-13 | |
| 21 | B47-K28 | 59968.359 | 7403.437 | 4.281 | 104-29-35 | |
| 22 | B47-K27 | 59967.288 | 7407.582 | 2.106 | 102-40-58 | |
| 23 | B47-KT26 | 59966.826 | 7409.637 | 0.827 | 102-40-58 | |

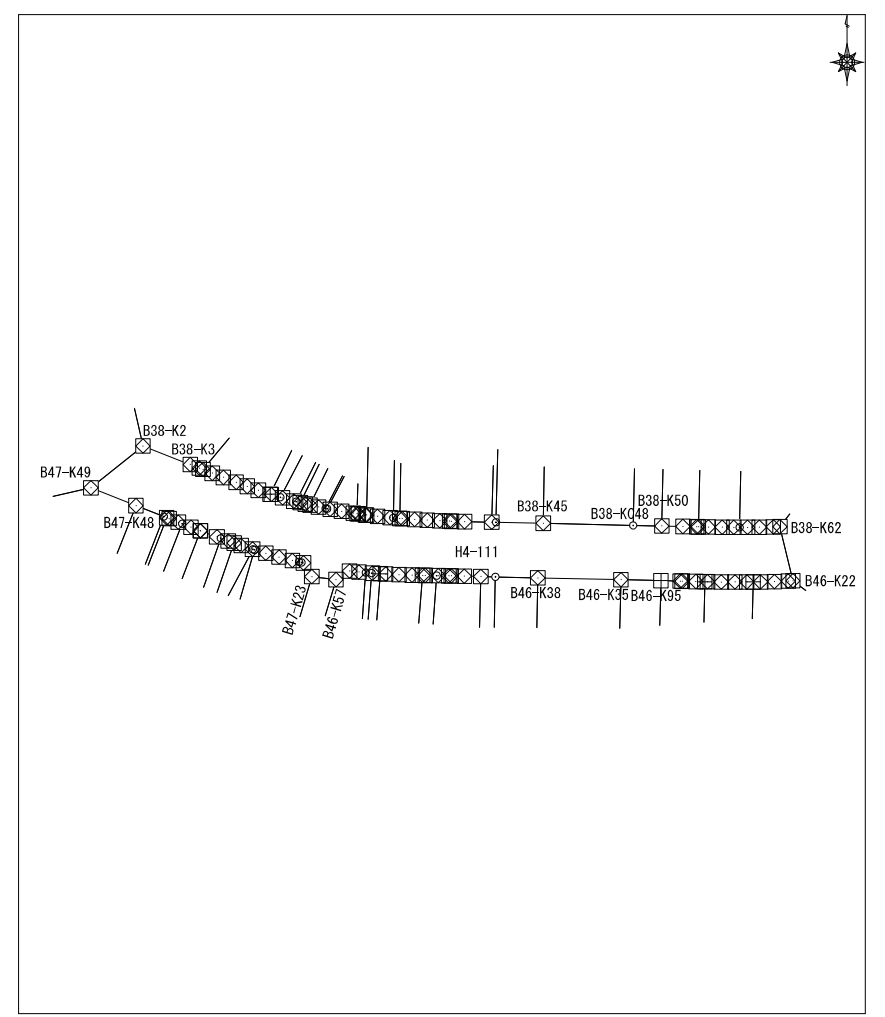

| | | | | |
|---|----|--|--------|--|
| 面積算出公式 $A=1/2 \sum X_n(Y_{(n+1)}-Y_{(n-1)})$ | 面積 | | 土地の所在 | |
| | 地積 | | 土地の所有者 | |

座標面積計算書

| | | | |
|----|-----------|----|--|
| 地番 | 平松4丁目111番 | 地目 | |
|----|-----------|----|--|

| No | 境界点 | X | Y | 辺長 | 方向角 | 備考 |
|----|-----------|-----------|----------|--------|-----------|----|
| 24 | B47-KC25 | 59966.644 | 7410.444 | 0.618 | 102-40-58 | |
| 25 | B47-K24 | 59966.508 | 7411.046 | 4.985 | 148-47-14 | |
| 26 | B47-K23 | 59962.245 | 7413.629 | 7.592 | 96-59-34 | |
| 27 | B46-K57 | 59961.321 | 7421.165 | 5.011 | 57-38-46 | |
| 28 | B46-K56 | 59964.002 | 7425.398 | 2.909 | 96-10-22 | |
| 29 | B46-K55 | 59963.689 | 7428.291 | 2.133 | 94-54-17 | |
| 30 | B46-KC54 | 59963.507 | 7430.416 | 1.847 | 94-54-17 | |
| 31 | B46-KC53 | 59963.349 | 7432.256 | 0.212 | 94-54-17 | |
| 32 | B46-K52 | 59963.331 | 7432.468 | 2.503 | 93-59-10 | |
| 33 | B46-K51 | 59963.157 | 7434.964 | 1.657 | 93-40-43 | |
| 34 | B46-K50 | 59963.051 | 7436.618 | 4.144 | 92-48-30 | |
| 35 | B46-K49 | 59962.848 | 7440.758 | 4.105 | 92-09-48 | |
| 36 | B46-K48 | 59962.693 | 7444.860 | 3.255 | 91-20-18 | |
| 37 | B46-K47 | 59962.617 | 7448.114 | 0.826 | 91-25-38 | |
| 38 | B46-K46 | 59962.596 | 7448.940 | 3.583 | 90-49-05 | |
| 39 | B46-KC201 | 59962.545 | 7452.522 | 0.478 | 90-49-05 | |
| 40 | B46-K45 | 59962.538 | 7453.001 | 3.260 | 90-45-10 | |
| 41 | B46-K44 | 59962.495 | 7456.261 | 0.774 | 90-55-29 | |
| 42 | B46-K43 | 59962.483 | 7457.035 | 4.071 | 91-13-49 | |
| 43 | B46-K42 | 59962.395 | 7461.105 | 5.086 | 91-13-24 | |
| 44 | B46-K41 | 59962.287 | 7466.190 | 4.496 | 91-19-49 | |
| 45 | B46-KC40 | 59962.182 | 7470.685 | 13.212 | 91-19-49 | |
| 46 | B46-K38 | 59961.876 | 7483.893 | 25.866 | 91-17-48 | |

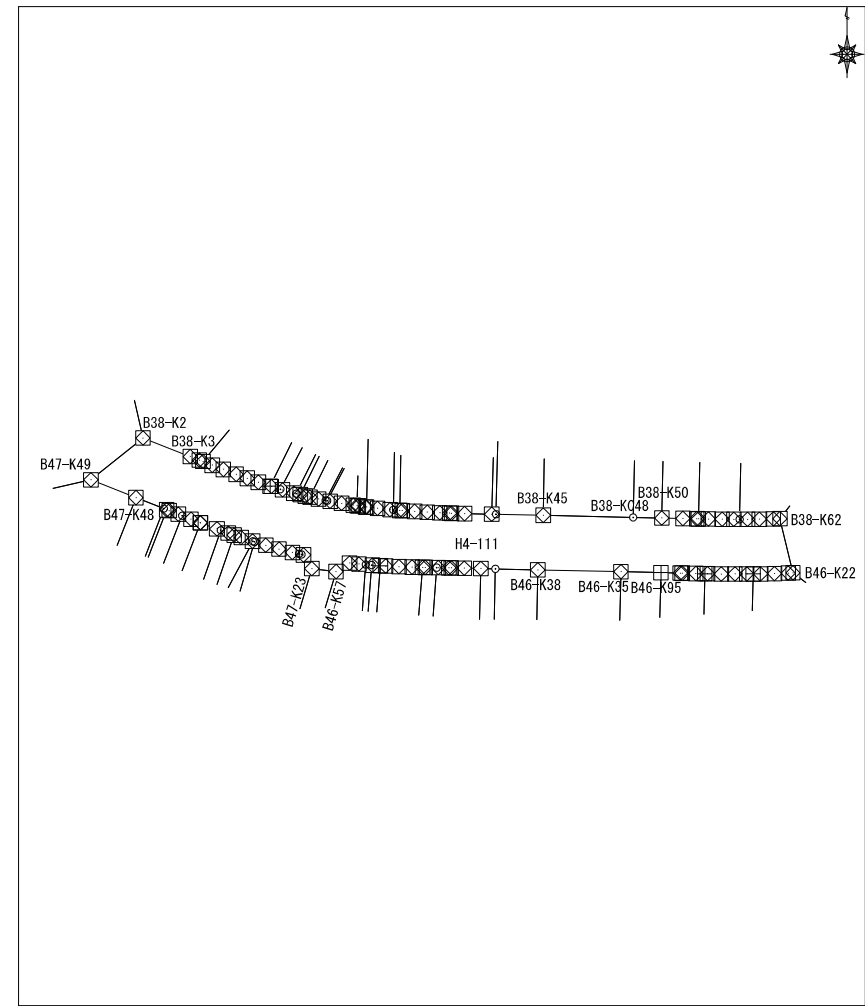

| | | |
|---|----|--|
| 面積算出公式 $A=1/2 \sum X_n(Y_{n+1}-Y_{n-1})$ | 面積 | |
| | 地積 | |

| | |
|--------|--|
| 土地の所在 | |
| 土地の所有者 | |

座標面積計算書

| | | | |
|----|-----------|----|--|
| 地番 | 平松4丁目111番 | 地目 | |
|----|-----------|----|--|

| No | 境界点 | X | Y | 辺長 | 方向角 | 備考 |
|----|----------|-----------|----------|--------|-----------|----|
| 47 | B46-K35 | 59961.290 | 7509.752 | 12.454 | 91-19-34 | |
| 48 | B46-K95 | 59961.002 | 7522.203 | 6.001 | 91-19-47 | |
| 49 | B46-K32 | 59960.863 | 7528.202 | 0.604 | 91-08-32 | |
| 50 | B46-K31 | 59960.851 | 7528.806 | 4.250 | 91-11-33 | |
| 51 | B46-K30 | 59960.762 | 7533.055 | 2.766 | 91-20-59 | |
| 52 | B46-K94 | 59960.697 | 7535.820 | 0.877 | 90-29-18 | |
| 53 | B46-K29 | 59960.690 | 7536.697 | 4.272 | 91-48-39 | |
| 54 | B46-K28 | 59960.555 | 7540.967 | 4.266 | 89-48-49 | |
| 55 | B46-K27 | 59960.569 | 7545.233 | 3.659 | 89-53-53 | |
| 56 | B46-K26 | 59960.575 | 7548.893 | 1.984 | 89-23-07 | |
| 57 | B46-K93 | 59960.596 | 7550.876 | 2.282 | 89-44-36 | |
| 58 | B46-K25 | 59960.607 | 7553.159 | 4.274 | 88-36-53 | |
| 59 | B46-K24 | 59960.710 | 7557.431 | 4.268 | 87-58-09 | |
| 60 | B46-K23 | 59960.861 | 7561.696 | 1.492 | 86-11-23 | |
| 61 | B46-K22 | 59960.960 | 7563.184 | 17.306 | 346-28-06 | |
| 62 | B38-K62 | 59977.786 | 7559.135 | 2.063 | 268-15-26 | |
| 63 | B38-K61 | 59977.723 | 7557.073 | 4.271 | 268-37-45 | |
| 64 | B38-K60 | 59977.621 | 7552.803 | 3.651 | 269-26-29 | |
| 65 | B38-K59 | 59977.585 | 7549.152 | 2.478 | 269-57-57 | |
| 66 | B38-KC58 | 59977.584 | 7546.674 | 1.786 | 269-57-57 | |
| 67 | B38-K57 | 59977.583 | 7544.888 | 3.656 | 270-34-30 | |
| 68 | B38-K56 | 59977.619 | 7541.233 | 4.270 | 270-49-50 | |
| 69 | B38-K55 | 59977.681 | 7536.964 | 3.062 | 271-02-32 | |

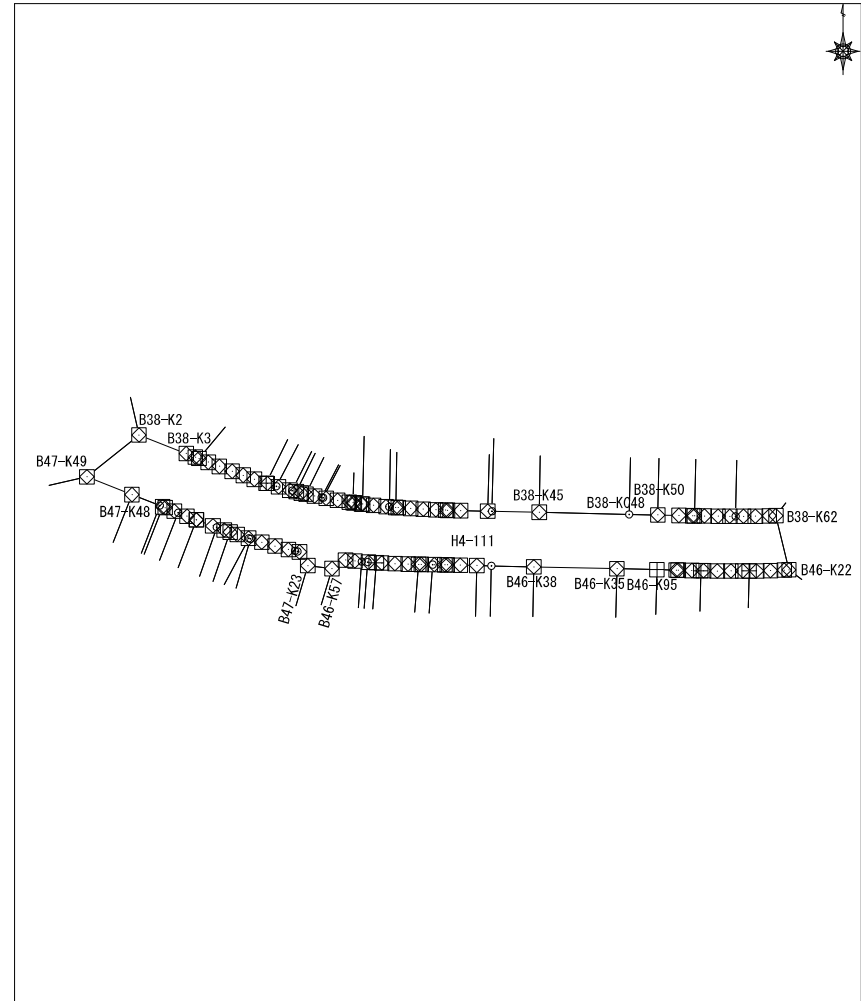

| | | |
|---|----|--|
| 面積算出公式 $A=1/2 \sum X_n(Y_{(n+1)}-Y_{(n-1)})$ | 面積 | |
| | 地積 | |

| | |
|--------|--|
| 土地の所在 | |
| 土地の所有者 | |

座標面積計算書

| | | | |
|----|-----------|----|--|
| 地番 | 平松4丁目111番 | 地目 | |
|----|-----------|----|--|

| No | 境界点 | X | Y | 辺長 | 方向角 | 備考 |
|----|-----------|-----------|----------|--------|-----------|----|
| 70 | B38-K54 | 59977.737 | 7533.902 | 0.587 | 271-58-25 | |
| 71 | B38-K53 | 59977.757 | 7533.316 | 4.272 | 271-19-10 | |
| 72 | B38-K52 | 59977.856 | 7529.045 | 6.603 | 271-14-46 | |
| 73 | B38-K50 | 59977.999 | 7522.444 | 8.884 | 271-17-47 | |
| 74 | B38-KC48 | 59978.200 | 7513.562 | 28.016 | 271-17-47 | |
| 75 | B38-K45 | 59978.834 | 7485.553 | 14.663 | 271-18-59 | |
| 76 | B38-KC211 | 59979.171 | 7470.894 | 1.309 | 271-18-59 | |
| 77 | B38-K44 | 59979.201 | 7469.585 | 8.388 | 271-15-22 | |
| 78 | B38-K43 | 59979.385 | 7461.199 | 4.078 | 271-24-05 | |
| 79 | B38-K42 | 59979.485 | 7457.123 | 0.607 | 271-31-54 | |
| 80 | B38-K41 | 59979.501 | 7456.515 | 3.037 | 272-23-35 | |
| 81 | B38-K40 | 59979.628 | 7453.481 | 3.939 | 272-30-36 | |
| 82 | B38-K39 | 59979.800 | 7449.546 | 3.910 | 273-28-04 | |
| 83 | B38-K38 | 59980.037 | 7445.643 | 3.897 | 274-00-55 | |
| 84 | B38-K37 | 59980.310 | 7441.755 | 0.780 | 274-40-47 | |
| 85 | B38-K36 | 59980.373 | 7440.978 | 2.003 | 274-51-00 | |
| 86 | B38-KC35 | 59980.542 | 7438.982 | 1.049 | 274-51-00 | |
| 87 | B38-K34 | 59980.631 | 7437.937 | 3.854 | 275-44-36 | |
| 88 | B38-K32 | 59981.017 | 7434.102 | 3.418 | 276-36-26 | |
| 89 | B38-K31 | 59981.410 | 7430.707 | 0.391 | 276-55-30 | |
| 90 | B38-K30 | 59981.457 | 7430.319 | 2.188 | 278-12-05 | |
| 91 | B38-K29 | 59981.769 | 7428.153 | 0.449 | 278-48-21 | |
| 92 | B38-K28 | 59981.838 | 7427.710 | 1.185 | 279-04-45 | |

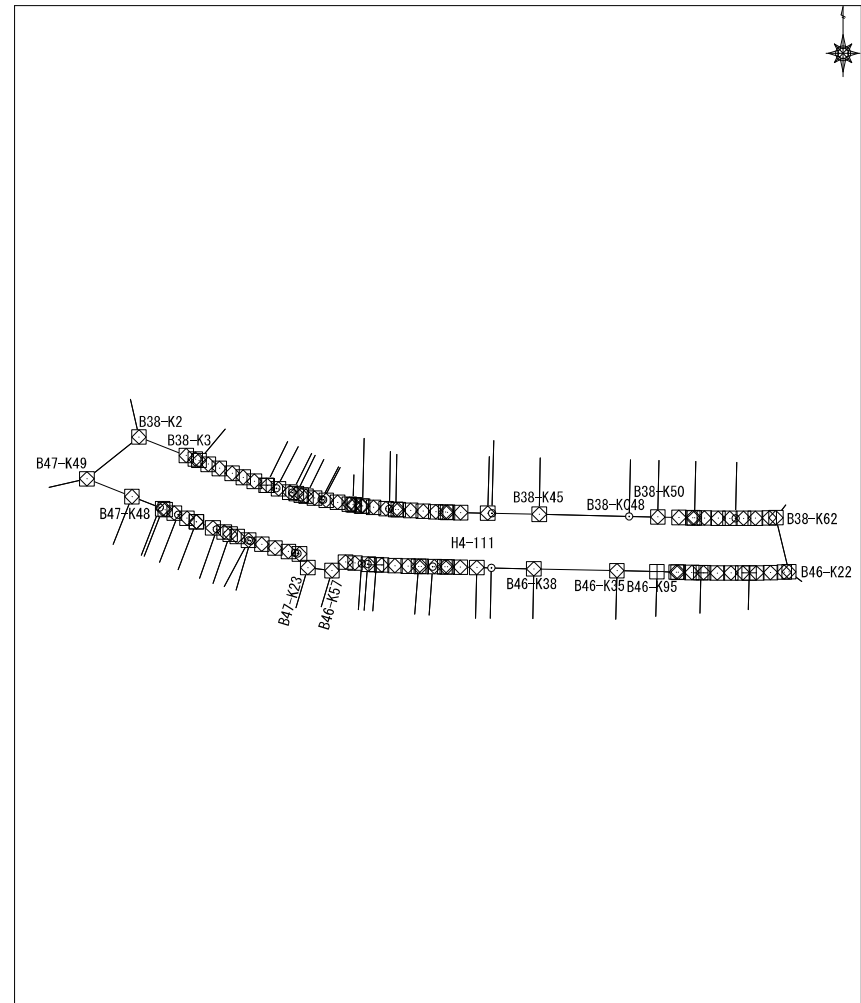

| | | | | |
|---|----|--|--------|--|
| 面積算出公式 $A=1/2 \sum X_n(Y_{(n+1)}-Y_{(n-1)})$ | 面積 | | 土地の所在 | |
| | 地積 | | 土地の所有者 | |

座標面積計算書

| | | | |
|----|-----------|----|--|
| 地番 | 平松4丁目111番 | 地目 | |
|----|-----------|----|--|

| No | 境界点 | X | Y | 辺長 | 方向角 | 備考 |
|-----|----------|-----------|----------|--------|-----------|----|
| 93 | B38-K26 | 59982.025 | 7426.539 | 3.662 | 278-55-54 | |
| 94 | B38-K25 | 59982.594 | 7422.922 | 3.661 | 279-21-42 | |
| 95 | B38-K24 | 59983.189 | 7419.310 | 0.931 | 281-32-30 | |
| 96 | B38-KT23 | 59983.375 | 7418.398 | 0.491 | 281-32-30 | |
| 97 | B38-KC22 | 59983.474 | 7417.916 | 2.239 | 281-32-30 | |
| 98 | B38-K21 | 59983.922 | 7415.722 | 2.752 | 282-37-59 | |
| 99 | B38-K20 | 59984.524 | 7413.037 | 1.478 | 283-09-30 | |
| 100 | B38-K19 | 59984.860 | 7411.598 | 1.606 | 284-22-35 | |
| 101 | B38-K18 | 59985.259 | 7410.042 | 1.282 | 284-15-14 | |
| 102 | B38-KC17 | 59985.575 | 7408.799 | 0.763 | 284-15-14 | |
| 103 | B38-K16 | 59985.763 | 7408.059 | 3.658 | 285-48-17 | |
| 104 | B38-K14 | 59986.759 | 7404.539 | 0.723 | 286-45-51 | |
| 105 | B38-KT13 | 59986.967 | 7403.847 | 2.937 | 286-45-51 | |
| 106 | B38-K12 | 59987.814 | 7401.036 | 0.378 | 288-30-35 | |
| 107 | B38-K11 | 59987.934 | 7400.677 | 3.870 | 288-17-03 | |
| 108 | B38-K10 | 59989.149 | 7397.002 | 3.664 | 289-03-35 | |
| 109 | B38-K9 | 59990.345 | 7393.539 | 3.651 | 290-00-14 | |
| 110 | B38-K8 | 59991.594 | 7390.108 | 4.254 | 290-08-58 | |
| 111 | B38-K7 | 59993.059 | 7386.115 | 3.666 | 291-08-01 | |
| 112 | B38-K6 | 59994.381 | 7382.695 | 3.070 | 291-26-50 | |
| 113 | B38-K5 | 59995.504 | 7379.838 | 1.187 | 291-13-52 | |
| 114 | B38-K4 | 59995.934 | 7378.731 | 3.060 | 291-26-46 | |
| 115 | B38-K3 | 59997.053 | 7375.883 | 15.781 | 291-22-03 | |

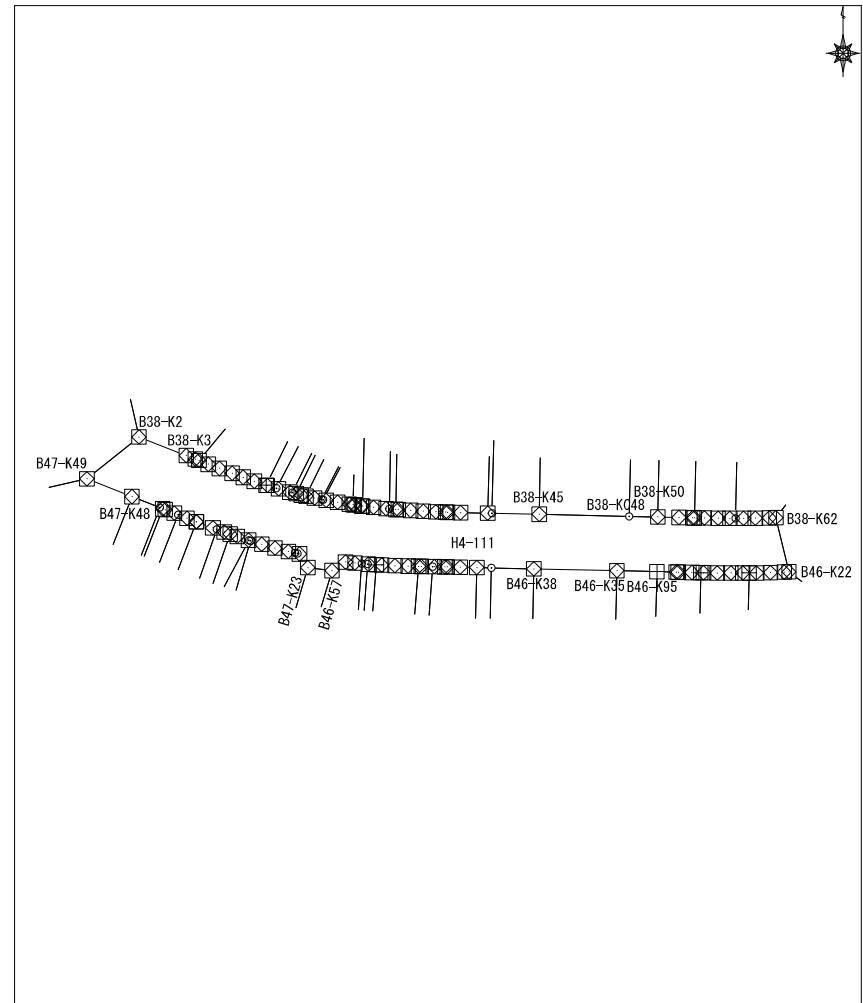

| | | | | |
|---|----|-------------|--------|--|
| 面積算出公式 $A=1/2 \sum X_n(Y_{(n+1)}-Y_{(n-1)})$ | 面積 | 3734.855545 | 土地の所在 | |
| | 地積 | 3734.85 | 土地の所有者 | |

座標面積計算書

| | | | | | | | 地番 | 平松4丁目112番 | 地目 | | | | | |
|----------------------------|---------|-----------|----------|-------|-------------|--------|----|-----------|----|--|--|--|--|--|
| No | 境界点 | X | Y | 辺長 | 方向角 | 備考 | | | | | | | | |
| 24 | B46-K57 | 59961.321 | 7421.165 | 7.592 | 276-59-34 | | | | | | | | | |
| | | | | | | | | | | | | | | |
| | | | | | | | | | | | | | | |
| | | | | | | | | | | | | | | |
| | | | | | | | | | | | | | | |
| | | | | | | | | | | | | | | |
| | | | | | | | | | | | | | | |
| | | | | | | | | | | | | | | |
| | | | | | | | | | | | | | | |
| | | | | | | | | | | | | | | |
| | | | | | | | | | | | | | | |
| | | | | | | | | | | | | | | |
| | | | | | | | | | | | | | | |
| | | | | | | | | | | | | | | |
| | | | | | | | | | | | | | | |
| | | | | | | | | | | | | | | |
| | | | | | | | | | | | | | | |
| | | | | | | | | | | | | | | |
| 面積算出公式 | | | | 面積 | 760.6890245 | 土地の所在 | | | | | | | | |
| A=1/2 Σ Xn (Y(n+1)-Y(n-1)) | | | | 地積 | 760.68 | 土地の所有者 | | | | | | | | |

座標面積計算書

| | | | | | | | 地番 | 平松4丁目113番 | 地目 | |
|----------------------------|----------|-----------|----------|--------|-----------|----|--------|-----------|----|--|
| No | 境界点 | X | Y | 辺長 | 方向角 | 備考 | | | | |
| 1 | B47-D1 | 59956.728 | 7345.969 | 4.005 | 201-26-16 | | | | | |
| 2 | B48-K32 | 59952.999 | 7344.505 | 4.010 | 168-59-46 | | | | | |
| 3 | B48-K31 | 59949.063 | 7345.270 | 6.178 | 225-50-39 | | | | | |
| 4 | B48-KC28 | 59944.759 | 7340.838 | 3.693 | 225-50-39 | | | | | |
| 5 | B48-K26 | 59942.187 | 7338.189 | 10.357 | 225-50-08 | | | | | |
| 6 | B48-K25 | 59934.971 | 7330.759 | 13.102 | 225-47-48 | | | | | |
| 7 | B48-K24 | 59925.836 | 7321.367 | 6.474 | 225-53-28 | | | | | |
| 8 | B48-D1 | 59921.330 | 7316.718 | 6.039 | 135-53-28 | | | | | |
| 9 | B49-K1 | 59916.994 | 7320.921 | 11.167 | 45-49-21 | | | | | |
| 10 | B49-KC44 | 59924.776 | 7328.930 | 7.339 | 45-49-21 | | | | | |
| 11 | B49-K43 | 59929.891 | 7334.193 | 11.485 | 45-47-09 | | | | | |
| 12 | B49-K42 | 59937.900 | 7342.425 | 1.835 | 45-38-55 | | | | | |
| 13 | B49-KC82 | 59939.183 | 7343.737 | 9.825 | 45-38-55 | | | | | |
| 14 | B49-K41 | 59946.051 | 7350.763 | 4.009 | 79-04-45 | | | | | |
| 15 | B49-K40 | 59946.810 | 7354.699 | 7.692 | 111-18-35 | | | | | |
| 16 | B49-KC39 | 59944.015 | 7361.865 | 1.903 | 111-18-35 | | | | | |
| 17 | B49-K38 | 59943.324 | 7363.638 | 9.609 | 111-27-55 | | | | | |
| 18 | B49-K37 | 59939.807 | 7372.580 | 2.897 | 110-43-54 | | | | | |
| 19 | B49-K36 | 59938.782 | 7375.289 | 0.532 | 110-42-32 | | | | | |
| 20 | B49-KC35 | 59938.594 | 7375.787 | 1.651 | 110-42-32 | | | | | |
| 21 | B49-K34 | 59938.010 | 7377.331 | 0.537 | 109-25-13 | | | | | |
| 22 | B49-KT33 | 59937.832 | 7377.837 | 4.565 | 109-25-13 | | | | | |
| 23 | B49-K32 | 59936.314 | 7382.142 | 5.099 | 107-55-32 | | | | | |
| 面積算出公式 | | | | 面積 | | | 土地の所在 | | | |
| A=1/2 Σ Xn (Y(n+1)-Y(n-1)) | | | | 地積 | | | 土地の所有者 | | | |

座標面積計算書

| | | | |
|----|-----------|----|--|
| 地番 | 平松4丁目113番 | 地目 | |
|----|-----------|----|--|

| No | 境界点 | X | Y | 辺長 | 方向角 | 備考 |
|----|----------|-----------|----------|--------|-----------|----|
| 24 | B49-K31 | 59934.744 | 7386.994 | 2.429 | 106-26-24 | |
| 25 | B49-K30 | 59934.057 | 7389.324 | 2.652 | 106-26-28 | |
| 26 | B49-K29 | 59933.306 | 7391.868 | 0.023 | 104-55-11 | |
| 27 | B49-KT28 | 59933.300 | 7391.890 | 5.074 | 104-55-11 | |
| 28 | B49-K27 | 59931.994 | 7396.793 | 3.955 | 103-34-06 | |
| 29 | B49-K26 | 59931.066 | 7400.637 | 4.998 | 149-08-04 | |
| 30 | B49-K25 | 59926.776 | 7403.201 | 13.094 | 16-22-12 | |
| 31 | B47-K21 | 59939.340 | 7406.892 | 4.985 | 239-01-00 | |
| 32 | B47-K20 | 59936.774 | 7402.618 | 4.252 | 283-27-33 | |
| 33 | B47-KC19 | 59937.763 | 7398.483 | 0.255 | 283-27-33 | |
| 34 | B47-K18 | 59937.823 | 7398.234 | 3.580 | 285-07-07 | |
| 35 | B47-KT17 | 59938.757 | 7394.778 | 1.348 | 285-07-07 | |
| 36 | B47-K16 | 59939.108 | 7393.477 | 0.894 | 286-18-47 | |
| 37 | B47-KC15 | 59939.359 | 7392.619 | 3.705 | 286-18-47 | |
| 38 | B47-K13 | 59940.400 | 7389.063 | 0.344 | 287-21-32 | |
| 39 | B47-K12 | 59940.503 | 7388.735 | 4.935 | 287-49-56 | |
| 40 | B47-K11 | 59942.014 | 7384.037 | 3.562 | 289-22-02 | |
| 41 | B47-KT10 | 59943.195 | 7380.676 | 1.276 | 289-22-02 | |
| 42 | B47-KC9 | 59943.618 | 7379.472 | 0.088 | 289-22-02 | |
| 43 | B47-K8 | 59943.648 | 7379.389 | 4.901 | 290-48-10 | |
| 44 | B47-K7 | 59945.388 | 7374.807 | 0.106 | 289-09-07 | |
| 45 | B47-K6 | 59945.423 | 7374.707 | 16.340 | 291-25-17 | |
| 46 | B47-K5 | 59951.391 | 7359.496 | 0.580 | 291-23-29 | |

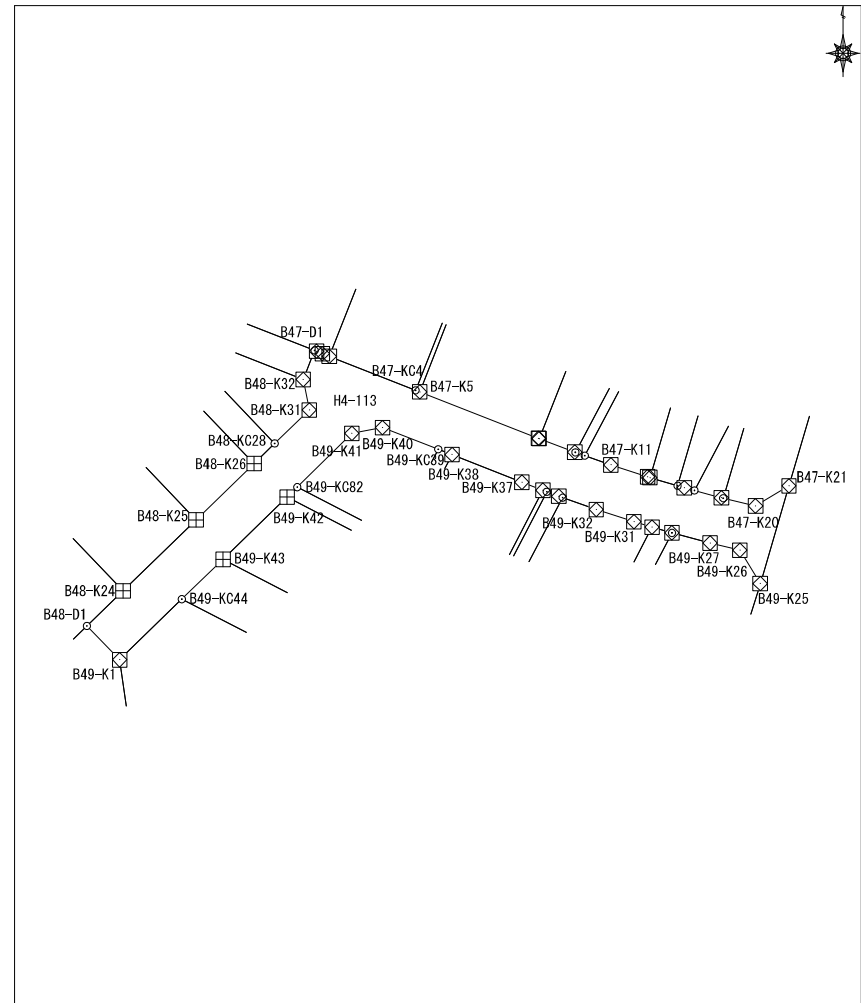

| | | | | |
|---|----|--|--------|--|
| 面積算出公式 $A=1/2 \sum X_n(Y_{n+1}-Y_{n-1})$ | 面積 | | 土地の所在 | |
| | 地積 | | 土地の所有者 | |

座標面積計算書

| | | | | | | | 地番 平松4丁目113番 | | 地目 | | | | | | |
|----------------------------|---------|-----------|----------|--------|-------------|--------|--------------|--|----|--|--|--|--|--|--|
| No | 境界点 | X | Y | 辺長 | 方向角 | 備考 | | | | | | | | | |
| 47 | B47-KC4 | 59951.602 | 7358.956 | 11.935 | 291-23-29 | | | | | | | | | | |
| 48 | B47-K2 | 59955.955 | 7347.843 | 0.958 | 291-21-54 | | | | | | | | | | |
| 49 | B47-K78 | 59956.305 | 7346.951 | 0.802 | 293-56-17 | | | | | | | | | | |
| 50 | B47-K77 | 59956.630 | 7346.217 | 0.267 | 291-26-16 | | | | | | | | | | |
| | | | | | | | | | | | | | | | |
| | | | | | | | | | | | | | | | |
| | | | | | | | | | | | | | | | |
| | | | | | | | | | | | | | | | |
| | | | | | | | | | | | | | | | |
| | | | | | | | | | | | | | | | |
| | | | | | | | | | | | | | | | |
| | | | | | | | | | | | | | | | |
| | | | | | | | | | | | | | | | |
| | | | | | | | | | | | | | | | |
| | | | | | | | | | | | | | | | |
| | | | | | | | | | | | | | | | |
| | | | | | | | | | | | | | | | |
| 面積算出公式 | | | | 面積 | 654.8434535 | 土地の所在 | | | | | | | | | |
| A=1/2 Σ Xn (Y(n+1)-Y(n-1)) | | | | 地積 | 654.84 | 土地の所有者 | | | | | | | | | |

座標面積計算書

| | | | | | | | 地番 | 平松4丁目114番 | 地目 | |
|----------------------------|-----------|-----------|----------|--------|-----------|----|--------|-----------|----|--|
| No | 境界点 | X | Y | 辺長 | 方向角 | 備考 | | | | |
| 1 | B46-K15 | 59937.424 | 7554.127 | 9.738 | 262-00-59 | | | | | |
| 2 | B46-KC14 | 59936.072 | 7544.483 | 15.071 | 262-00-59 | | | | | |
| 3 | B46-K13 | 59933.979 | 7529.558 | 10.796 | 262-02-35 | | | | | |
| 4 | B46-KC12 | 59932.484 | 7518.866 | 1.666 | 262-02-35 | | | | | |
| 5 | B46-K11 | 59932.253 | 7517.216 | 5.288 | 262-00-48 | | | | | |
| 6 | B46-K10 | 59931.519 | 7511.979 | 5.810 | 268-24-23 | | | | | |
| 7 | B46-KC100 | 59931.357 | 7506.171 | 15.928 | 268-24-23 | | | | | |
| 8 | B46-K8 | 59930.914 | 7490.249 | 25.914 | 268-25-31 | | | | | |
| 9 | B46-K6 | 59930.202 | 7464.346 | 1.053 | 275-28-15 | | | | | |
| 10 | B46-K5 | 59930.302 | 7463.298 | 17.447 | 275-23-21 | | | | | |
| 11 | B46-K4 | 59931.941 | 7445.928 | 19.745 | 275-20-11 | | | | | |
| 12 | B46-K3 | 59933.777 | 7426.269 | 8.972 | 275-25-15 | | | | | |
| 13 | B46-K2 | 59934.625 | 7417.337 | 4.992 | 325-51-30 | | | | | |
| 14 | B46-K1 | 59938.757 | 7414.535 | 13.279 | 196-22-46 | | | | | |
| 15 | B45-K19 | 59926.017 | 7410.790 | 5.003 | 55-52-41 | | | | | |
| 16 | B45-K18 | 59928.823 | 7414.932 | 5.253 | 95-26-14 | | | | | |
| 17 | B45-K17 | 59928.326 | 7420.162 | 31.805 | 95-22-24 | | | | | |
| 18 | B45-K16 | 59925.347 | 7451.827 | 6.827 | 95-23-23 | | | | | |
| 19 | B45-K15 | 59924.706 | 7458.624 | 13.131 | 91-18-26 | | | | | |
| 20 | B44-K44 | 59924.406 | 7471.752 | 5.072 | 88-23-22 | | | | | |
| 21 | B44-KC43 | 59924.549 | 7476.822 | 4.587 | 88-23-22 | | | | | |
| 22 | B44-K41 | 59924.678 | 7481.407 | 14.585 | 88-26-25 | | | | | |
| 23 | B44-K40 | 59925.075 | 7495.987 | 0.639 | 88-23-24 | | | | | |
| 面積算出公式 | | | | 面積 | | | 土地の所在 | | | |
| A=1/2 Σ Xn (Y(n+1)-Y(n-1)) | | | | 地積 | | | 土地の所有者 | | | |

座標面積計算書

| | | | | | | | 地番 | 平松4丁目115番 | 地目 | |
|----------------------------|---------|-----------|----------|--------|-----------|----|--------|-----------|----|--|
| No | 境界点 | X | Y | 辺長 | 方向角 | 備考 | | | | |
| 1 | B43-K8 | 59881.887 | 7573.914 | 7.537 | 259-46-17 | | | | | |
| 2 | B43-KC7 | 59880.548 | 7566.497 | 1.972 | 259-46-17 | | | | | |
| 3 | B43-K6 | 59880.198 | 7564.556 | 1.263 | 259-43-56 | | | | | |
| 4 | B43-K5 | 59879.973 | 7563.313 | 1.321 | 259-51-56 | | | | | |
| 5 | B43-K4 | 59879.741 | 7562.013 | 7.694 | 257-53-18 | | | | | |
| 6 | B43-K56 | 59878.126 | 7554.490 | 9.225 | 260-02-44 | | | | | |
| 7 | B43-K3 | 59876.532 | 7545.405 | 20.915 | 260-03-01 | | | | | |
| 8 | B43-K2 | 59872.918 | 7524.805 | 8.255 | 262-20-25 | | | | | |
| 9 | B44-K24 | 59871.818 | 7516.623 | 7.400 | 261-11-37 | | | | | |
| 10 | B44-K23 | 59870.685 | 7509.310 | 8.389 | 262-54-05 | | | | | |
| 11 | B44-K9 | 59869.648 | 7500.986 | 8.208 | 269-07-34 | | | | | |
| 12 | B44-KC8 | 59869.523 | 7492.779 | 1.579 | 269-07-34 | | | | | |
| 13 | B44-K6 | 59869.499 | 7491.200 | 1.953 | 268-50-56 | | | | | |
| 14 | B44-KC4 | 59869.460 | 7489.247 | 0.862 | 268-50-56 | | | | | |
| 15 | B44-K3 | 59869.442 | 7488.385 | 6.965 | 269-01-06 | | | | | |
| 16 | B44-K2 | 59869.323 | 7481.422 | 13.705 | 272-02-19 | | | | | |
| 17 | B45-K8 | 59869.811 | 7467.725 | 10.767 | 274-21-34 | | | | | |
| 18 | B45-K7 | 59870.629 | 7456.990 | 10.811 | 275-20-15 | | | | | |
| 19 | B45-K6 | 59871.635 | 7446.226 | 0.251 | 275-40-58 | | | | | |
| 20 | B45-K5 | 59871.660 | 7445.976 | 18.477 | 275-01-43 | | | | | |
| 21 | B45-K4 | 59873.279 | 7427.570 | 13.903 | 273-16-13 | | | | | |
| 22 | B45-K3 | 59874.072 | 7413.690 | 13.872 | 273-09-48 | | | | | |
| 23 | B45-K2 | 59874.838 | 7399.840 | 5.007 | 324-56-34 | | | | | |
| 面積算出公式 | | | | 面積 | | | 土地の所在 | | | |
| A=1/2 Σ Xn (Y(n+1)-Y(n-1)) | | | | 地積 | | | 土地の所有者 | | | |

座標面積計算書

| | | | | | | | 地番 | 平松4丁目115番 | 地目 | | | | | |
|----------------------------|--------|-----------|----------|--------|------------|--------|----|-----------|----|--|--|--|--|--|
| No | 境界点 | X | Y | 辺長 | 方向角 | 備考 | | | | | | | | |
| 24 | B45-K1 | 59878.936 | 7396.964 | 9.148 | 196-17-43 | | | | | | | | | |
| 25 | K-77 | 59870.155 | 7394.397 | 18.535 | 93-18-49 | | | | | | | | | |
| 26 | K-76 | 59869.084 | 7412.901 | 14.332 | 93-07-59 | | | | | | | | | |
| 27 | K-75 | 59868.301 | 7427.211 | 18.393 | 95-03-52 | | | | | | | | | |
| 28 | K-74 | 59866.677 | 7445.532 | 11.097 | 95-19-07 | | | | | | | | | |
| 29 | K-73 | 59865.648 | 7456.581 | 15.321 | 94-25-21 | | | | | | | | | |
| 30 | K-72 | 59864.467 | 7471.857 | 3.923 | 93-53-13 | | | | | | | | | |
| 31 | K-71 | 59864.201 | 7475.771 | 12.682 | 88-58-24 | | | | | | | | | |
| 32 | K-70 | 59864.428 | 7488.451 | 14.629 | 89-03-24 | | | | | | | | | |
| 33 | K-69 | 59864.669 | 7503.078 | 16.519 | 81-15-36 | | | | | | | | | |
| 34 | K-68 | 59867.179 | 7519.406 | 4.036 | 84-00-15 | | | | | | | | | |
| 35 | K-67 | 59867.601 | 7523.420 | 32.544 | 80-05-19 | | | | | | | | | |
| 36 | K-66 | 59873.203 | 7555.478 | 7.721 | 77-44-05 | | | | | | | | | |
| 37 | K-65 | 59874.843 | 7563.023 | 11.232 | 79-36-22 | | | | | | | | | |
| 38 | K-64 | 59876.869 | 7574.071 | 6.093 | 78-47-11 | | | | | | | | | |
| 39 | K-D3 | 59878.054 | 7580.047 | 4.969 | 348-47-11 | | | | | | | | | |
| 40 | B43-K9 | 59882.928 | 7579.081 | 5.271 | 258-36-12 | | | | | | | | | |
| 面積算出公式 | | | | 面積 | 940.841477 | 土地の所在 | | | | | | | | |
| A=1/2 Σ Xn (Y(n+1)-Y(n-1)) | | | | 地積 | 940.84 | 土地の所有者 | | | | | | | | |

座標面積計算書

| | | | | | | | 地番 | 平松4丁目116番 | 地目 | |
|-----------------------------------|----------|-----------|----------|--------|------------|--------|----|-----------|----|--|
| No | 境界点 | X | Y | 辺長 | 方向角 | 備考 | | | | |
| 1 | B45-K15 | 59924.706 | 7458.624 | 5.013 | 131-55-47 | | | | | |
| 2 | B45-K14 | 59921.356 | 7462.354 | 15.544 | 168-45-54 | | | | | |
| 3 | B45-KC13 | 59906.110 | 7465.383 | 3.110 | 168-45-54 | | | | | |
| 4 | B45-K12 | 59903.059 | 7465.989 | 2.944 | 168-47-27 | | | | | |
| 5 | B45-KC11 | 59900.171 | 7466.561 | 6.490 | 168-47-27 | | | | | |
| 6 | B45-K10 | 59893.804 | 7467.823 | 19.864 | 168-43-55 | | | | | |
| 7 | B45-K9 | 59874.323 | 7471.704 | 6.016 | 221-24-00 | | | | | |
| 8 | B45-K8 | 59869.811 | 7467.725 | 13.705 | 92-02-19 | | | | | |
| 9 | B44-K2 | 59869.323 | 7481.422 | 4.001 | 308-55-19 | | | | | |
| 10 | B44-K1 | 59871.837 | 7478.309 | 14.352 | 348-48-59 | | | | | |
| 11 | B44-K49 | 59885.917 | 7475.525 | 3.941 | 348-46-18 | | | | | |
| 12 | B44-K48 | 59889.782 | 7474.758 | 0.921 | 348-40-29 | | | | | |
| 13 | B44-K47 | 59890.685 | 7474.577 | 13.188 | 348-45-35 | | | | | |
| 14 | B44-K46 | 59903.619 | 7472.006 | 17.208 | 348-43-53 | | | | | |
| 15 | B44-K45 | 59920.495 | 7468.644 | 4.996 | 38-28-35 | | | | | |
| 16 | B44-K44 | 59924.406 | 7471.752 | 13.131 | 271-18-26 | | | | | |
| 面積算出公式 | | | | 面積 | 364.482244 | 土地の所在 | | | | |
| $A=1/2 \sum X_n(Y_{n+1}-Y_{n-1})$ | | | | 地積 | 364.48 | 土地の所有者 | | | | |

座標面積計算書

| | | | | | | | 地番 | 平松4丁目117番 | 地目 | |
|-----------------------------------|----------|-----------|----------|--------|-------------|--------|----|-----------|----|--|
| No | 境界点 | X | Y | 辺長 | 方向角 | 備考 | | | | |
| 1 | B44-K15 | 59905.559 | 7499.211 | 3.338 | 207-03-37 | | | | | |
| 2 | B44-K14 | 59902.587 | 7497.692 | 13.943 | 170-20-48 | | | | | |
| 3 | B44-KC13 | 59888.841 | 7500.030 | 3.071 | 170-20-48 | | | | | |
| 4 | B44-K11 | 59885.814 | 7500.545 | 14.067 | 170-20-58 | | | | | |
| 5 | B44-KR10 | 59871.946 | 7502.903 | 2.993 | 219-51-03 | | | | | |
| 6 | B44-K9 | 59869.648 | 7500.986 | 8.389 | 82-54-05 | | | | | |
| 7 | B44-K23 | 59870.685 | 7509.310 | 3.005 | 305-54-12 | | | | | |
| 8 | B44-K22 | 59872.447 | 7506.876 | 12.120 | 350-21-05 | | | | | |
| 9 | B44-KC21 | 59884.395 | 7504.845 | 1.963 | 350-21-05 | | | | | |
| 10 | B44-K19 | 59886.331 | 7504.516 | 3.399 | 350-21-18 | | | | | |
| 11 | B44-KC17 | 59889.682 | 7503.947 | 13.779 | 350-21-18 | | | | | |
| 12 | B44-K16 | 59903.265 | 7501.638 | 2.293 | 313-22-54 | | | | | |
| 13 | B44-KC66 | 59904.841 | 7499.971 | 1.046 | 313-22-54 | | | | | |
| 面積算出公式 | | | | 面積 | 142.7719785 | 土地の所在 | | | | |
| $A=1/2 \sum X_n(Y_{n+1}-Y_{n-1})$ | | | | 地積 | 142.77 | 土地の所有者 | | | | |

座標面積計算書

| No | 境界点 | X | Y | 辺長 | 方向角 | 備考 |
|----|----------|-----------|----------|--------|-----------|----|
| 1 | B43-K29 | 59926.153 | 7516.858 | 8.139 | 264-55-43 | |
| 2 | B44-K38 | 59925.434 | 7508.751 | 2.998 | 129-16-11 | |
| 3 | B44-KR37 | 59923.536 | 7511.072 | 11.175 | 169-32-08 | |
| 4 | B44-K36 | 59912.547 | 7513.101 | 3.987 | 169-30-30 | |
| 5 | B44-K35 | 59908.627 | 7513.827 | 2.858 | 169-57-23 | |
| 6 | B44-K33 | 59905.812 | 7514.326 | 0.568 | 171-13-34 | |
| 7 | B44-K34 | 59905.251 | 7514.413 | 3.426 | 171-33-55 | |
| 8 | B44-K32 | 59901.863 | 7514.915 | 3.984 | 172-15-53 | |
| 9 | B44-K67 | 59897.915 | 7515.451 | 4.001 | 172-37-16 | |
| 10 | B44-KR31 | 59893.947 | 7515.965 | 2.567 | 172-53-47 | |
| 11 | B44-KC30 | 59891.400 | 7516.283 | 3.398 | 172-53-47 | |
| 12 | B44-KR28 | 59888.028 | 7516.703 | 1.963 | 172-52-54 | |
| 13 | B44-KC26 | 59886.081 | 7516.946 | 11.949 | 172-52-54 | |
| 14 | B44-K25 | 59874.224 | 7518.427 | 3.007 | 216-51-22 | |
| 15 | B44-K24 | 59871.818 | 7516.623 | 8.255 | 82-20-25 | |
| 16 | B43-K2 | 59872.918 | 7524.805 | 2.989 | 306-34-27 | |
| 17 | B43-KR1 | 59874.699 | 7522.404 | 20.961 | 352-52-10 | |
| 18 | B43-KR36 | 59895.498 | 7519.803 | 5.970 | 352-37-08 | |
| 19 | B43-K35 | 59901.418 | 7519.036 | 0.062 | 352-49-12 | |
| 20 | B43-K34 | 59901.480 | 7519.028 | 3.992 | 351-44-12 | |
| 21 | B43-K33 | 59905.430 | 7518.454 | 3.946 | 350-02-45 | |
| 22 | B43-K32 | 59909.317 | 7517.772 | 4.037 | 349-29-14 | |
| 23 | B43-K31 | 59913.286 | 7517.035 | 10.609 | 349-31-22 | |

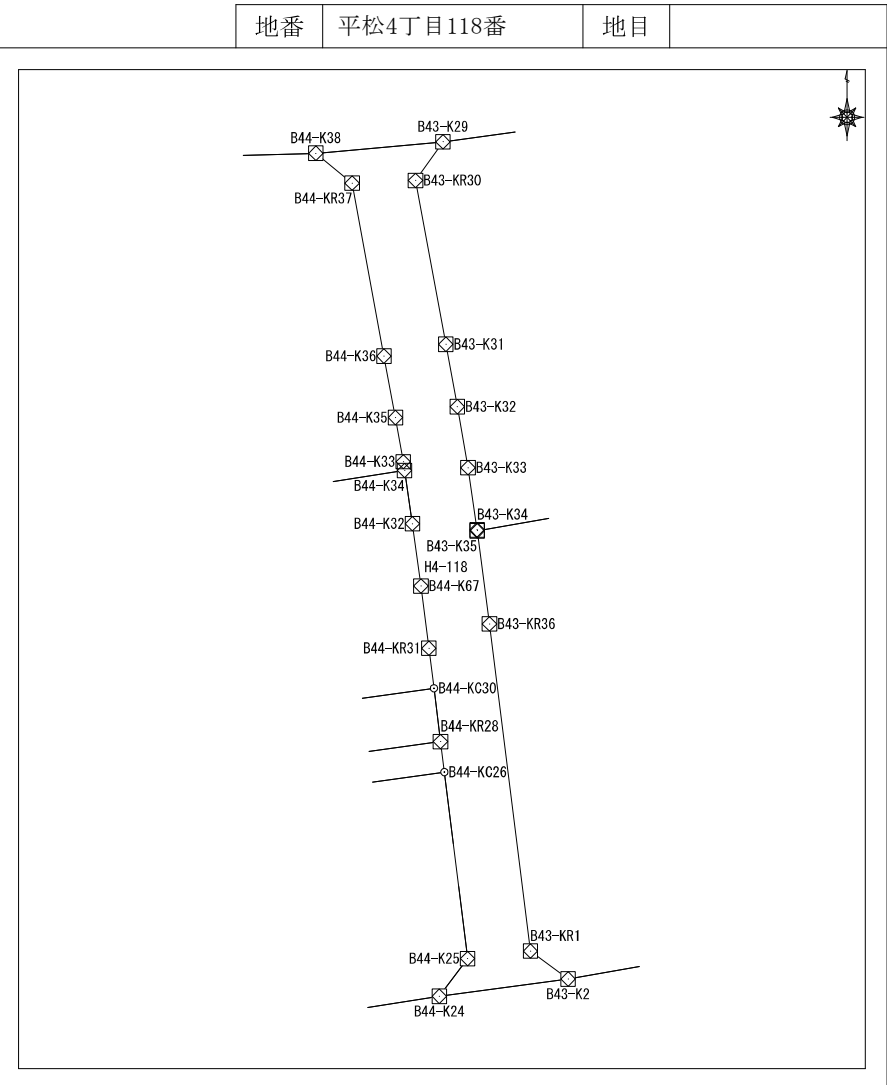

| | | | | |
|--|----|--|--------|--|
| 面積算出公式 $A=1/2 \sum X_n (Y_{(n+1)} - Y_{(n-1)})$ | 面積 | | 土地の所在 | |
| | 地積 | | 土地の所有者 | |

座標面積計算書

| | | | | | | | 地番 | 平松4丁目118番 | 地目 | |
|----------------------------|----------|-----------|----------|-------|------------|--------|----|-----------|----|--|
| No | 境界点 | X | Y | 辺長 | 方向角 | 備考 | | | | |
| 24 | B43-KR30 | 59923.719 | 7515.106 | 2.999 | 35-44-30 | | | | | |
| | | | | | | | | | | |
| | | | | | | | | | | |
| | | | | | | | | | | |
| | | | | | | | | | | |
| | | | | | | | | | | |
| | | | | | | | | | | |
| | | | | | | | | | | |
| | | | | | | | | | | |
| | | | | | | | | | | |
| | | | | | | | | | | |
| | | | | | | | | | | |
| | | | | | | | | | | |
| | | | | | | | | | | |
| 面積算出公式 | | | | 面積 | 225.405062 | 土地の所在 | | | | |
| A=1/2 Σ Xn (Y(n+1)-Y(n-1)) | | | | 地積 | 225.40 | 土地の所有者 | | | | |